

EZBlend™ Chemical Transfer Unit

Operation Manual

CTX2V-EZB

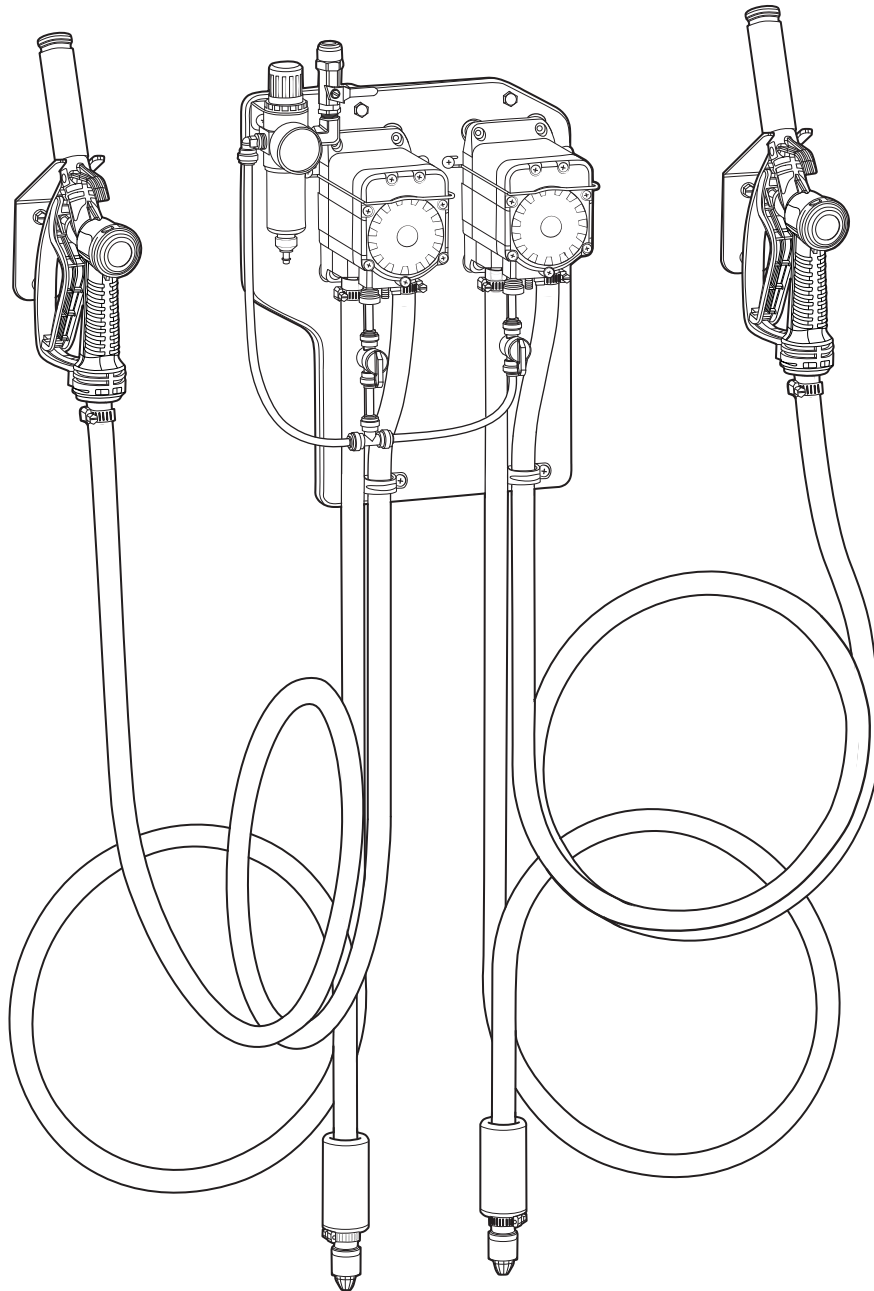

READ ALL INSTRUCTIONS BEFORE USING OR
SERVICING THIS UNIT. KEEP THIS MANUAL IN A
LOCATION THAT IS READILY AVAILABLE TO USERS
AND SERVICE TECHNICIANS.

English (Original Instructions)



Scan this code for
operation manual

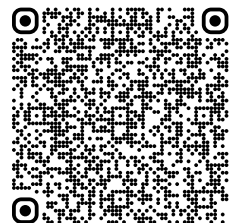

Safety

WARNING

PEOPLE OR OBJECTS CAN BE HURT OR DAMAGED IF THIS UNIT IS NOT USED CORRECTLY!



Failure to read all the instructions before operating the unit may result in personal injury or death from the improper use or the chemical solution. Anyone handling, operating or using the unit must read and understand the instructions in the manual. The buyer assumes all responsibility for safety and proper use in accordance with the instructions.



Using or servicing the unit without appropriate personal protective equipment (PPE) may result in serious injury such as burns, rashes, eye, throat or lung damage and death. Always wear PPE as indicated in the Safety Data Sheet (SDS) when using or servicing the unit. Protect eyes, skin, and lungs against drifting spray.



Chemical solutions may pose a health risk and death if they contact the skin or eyes, are inhaled or swallowed. Always read and follow all chemical safety precautions and handling instructions provided by the chemical manufacturer and the SDS associated with the chemical solution before using the unit.



Pressure within the equipment may cause an unexpected release of the chemical solution and cause serious injury such as burns, rashes, eye damage, throat or lung damage and death. Always depressurize and clean the unit after each use. Never leave the unit unattended while pressurized.

Using the unit with fluid temperatures above 100°F (37.8°C) may result in scalding, burns, serious injury or death. DO NOT use a solution with a temperature above 100°F (37.8°C).

Operating the unit when damaged or leaking may result in exposure to chemical solutions, serious injury or death. Never use the unit if it is damaged or leaking.

Never point the discharge wand at yourself, another person, or any object you do not want covered in chemical.



Using incoming air pressure exceeding 100 psi (6.9 bar) may result in pressure buildup, explosion, serious injury or death. DO NOT exceed 100 psi (6.9 bar) incoming air pressure when operating the unit.

Use of hydrocarbons and flammable products may result in explosions, fire and serious injury or death. Never use hydrocarbons or flammable products with the unit.



Mixing an alkaline with an acid may result in a chemical reaction. Overheating of the mixture may cause it to splatter caustic compounds or release hazardous fumes, gas and vapors. Always flush the unit with fresh water thoroughly when switching from an alkaline to an acid or an acid to an alkaline.

NOTICE

Servicing or modifying this unit with parts not listed in this manual may cause the unit to operate improperly. Do not use unauthorized parts when servicing the unit.

Use of an air lubricator before the unit may result in diminished performance and damage to the unit. Do not use an air lubricator before the unit.

Moisture in the air lines will damage the pump and diminish the pump life. The air must be filtered, clean, dry and free of moisture. If needed, install an air dryer before the unit.

PROTECT THE ENVIRONMENT



Please dispose of packaging materials, old machine components, and hazardous fluids in an environmentally safe way according to local waste disposal regulations

Product Overview

Special Instructions

This unit is configured specifically for transferring Sterilex products. Acceptable products are listed below.

Sterilex “Solution 1 / Disinfectant” Products	Sterilex “Solution 2 / Activator” Products
Sterilex® Ultra Disinfectant Cleaner Solution 1 (US)	Sterilex® Ultra ActivatorSolution (US)
Sterilex® Ultra CIP (US)	Ultra Soft Metal Activator (US)
Sterilex® Ultra-Kleen Solution: Solution 1 (Canada)	Sterilex® Ultra-Kleen Solution: Solution 2 (Canada)
Sterilex® Ultra Soft Metal Disinfectant Cleaner (Canada)	Sterilex® Ultra Soft MetalActivator (Canada)

Note: Always affix Sterilex chemical jug tags on each jug. Contact your Sterilex product chemical vendor for jug tags.

Requirements

Compressed air requirements	20-80 psi (1.4-5.5 bar) with 2 cfm (56.6 l/min)
Liquid temperature range	40-100°F (4.4-37.8°C)
Chemical compatibility	This unit is specifically configured for use with Sterilex liquid products. For more information on chemical compatibility, consult the manufacturer or SDS for your product or contact our customer service department.

Specifications

Power type	Compressed air
Chemical pickup type	Draws from concentrated product
Number of products unit can draw from	One product per pump
Suction line length/diameter	8 ft. (2.4 m) hose with ½ in. (12.7 mm) inside diameter
Discharge hose length/diameter	8 ft. (2.4 m) hose, with ½ in. (12.7 mm) inside diameter
Discharge wand/tip type	Polypropylene fill gun with ½ in. hose barb and Hastelloy spring
Flow rate*	3.5 gal/min (13.2 l/min) per pump
Pump seals	Viton

*Flow rates given are based on chemical with viscosity of water and factory air pressure settings.

Product Components

Get to know the CTX2V-EZB components that you will need to use, adjust or assemble.

EZBlend™ Chemical Transfer Unit • Two pump

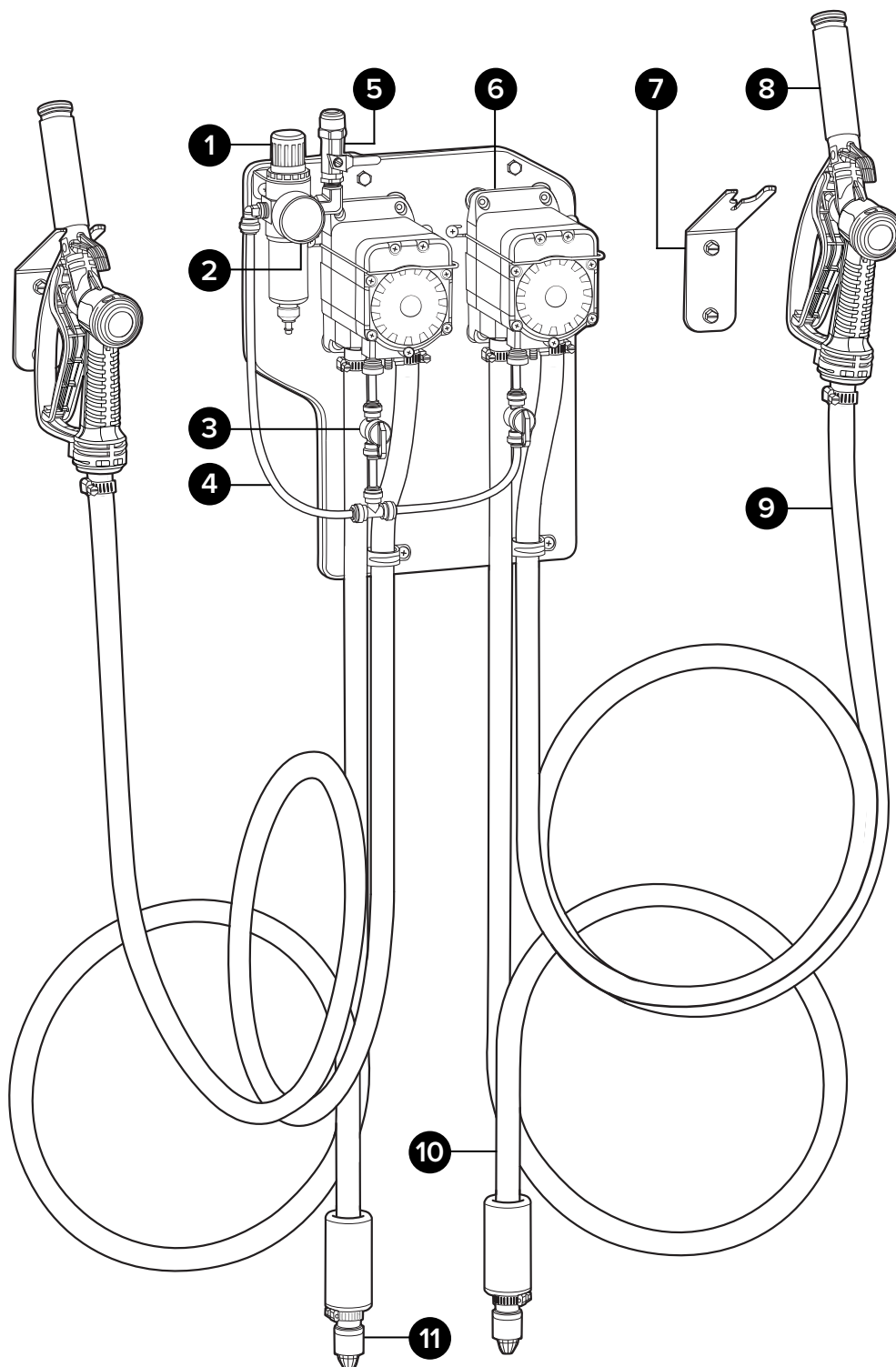

1. Air regulator
2. Air pressure gauge
3. Quick-fit shut off valve
4. Air line
5. Air inlet valve
6. Quick-change pump
7. Wand bracket
8. Poly fill gun
9. Discharge hose
10. Suction hose
11. Suction valve

Using your unit

Installation Instructions

1. Remove components from packaging.
2. Select desired area to mount the unit.
3. Mount the unit to the wall using the longer screws and plastic anchors provided in the parts package.

NOTE: To drill holes for the plastic anchors, use a $\frac{5}{16}$ inch drill bit.

4. If desired, mount the wand brackets using the screws and plastic anchors provided in the parts package.

Operating Instructions

NOTE: Follow color coding indicators for proper dispensing. Incorrect dispensing may minimize effectiveness of solutions or result in off label product usage.

5. With the air inlet valve in the closed position, connect $\frac{3}{8}$ inch tubing air line to the air inlet quick-fit.
6. Follow all Sterilex product label instructions when using product. Place the chemical suction line into a container of chemical solution.

NOTE: Only use blue chemical suction line for Sterilex "Solution 1" product and green chemical suction line for Sterilex "Solution 2 / Activator" product.

7. Open the air inlet valve to allow air flow.
8. Verify the quick-fit shut off valves are open.
9. Place poly fill gun into an approved container.
10. Activate the unit by pulling the trigger handle on the poly fill gun. Release the trigger to stop the flow of product.

NOTE: For safe and effective operation, it is recommended to only activate one pump at a time.

11. Close the air inlet valve to stop the air flow.

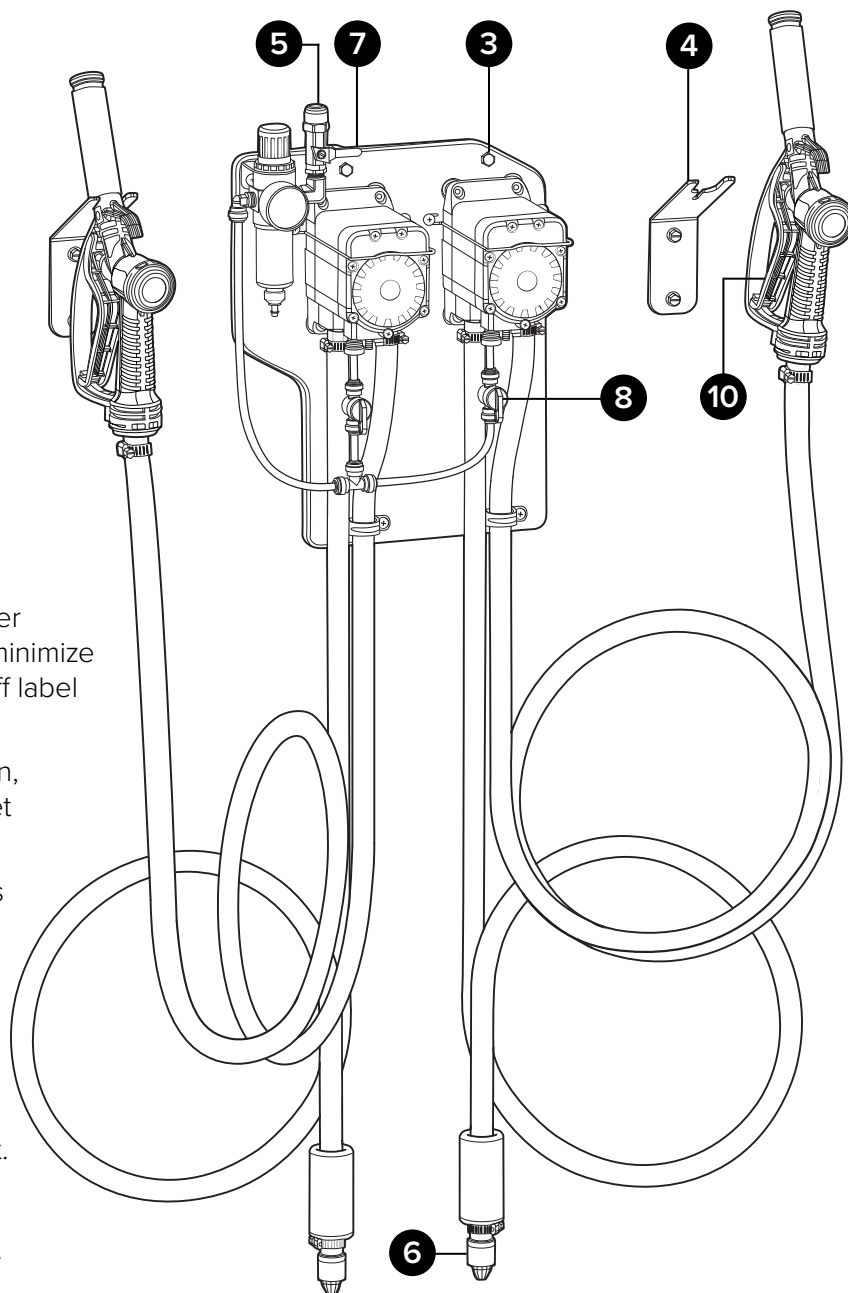

After Use Instructions

NOTE: To ensure safety, always depressurize the unit when not in use and prior to disassembly or maintenance.

12. Shut off the air supply to the unit by closing the air inlet valve and removing air line.
13. Pull the trigger handle on the poly fill guns to relieve any pressure remaining in the unit.
14. Release trigger handle after all pressure has been relieved from the unit.

Maintenance

WARNING

Performing any maintenance with the unit pressurized, and connected to the air supply may result in serious injury or death. Always ensure that the unit has been depressurized, and disconnected from the air supply before conducting any maintenance. Servicing or modifying this unit with parts not listed in this manual may cause the unit to operate improperly. Do not use unauthorized parts when servicing the unit.

Maintaining Your Unit

To keep your unit operating properly, periodically perform the following maintenance procedures:

- Inspect the pump for wear and leaks.
 - Inspect all hoses for leaks or excessive wear. Make sure all hose clamps are in good condition and properly secured.
 - Replace the filter located within the air regulator as needed. Clean by unthreading the air regulator bowl from the air regulator.
 - Check the suction line and strainer for debris. Clean as needed.
 - Drain your air compressor tank on a regular basis to help extend pump life. An air source with a high moisture content will accelerate pump wear.
- Note:** If your air source has a high moisture content, install a water separator.

Servicing Your Unit

To service your unit, refer to the service manual which includes:

- Troubleshooting procedures.
- Detailed parts breakdowns and illustrations.
- Part numbers of serviceable components and assemblies.



Scan this code for
service manual

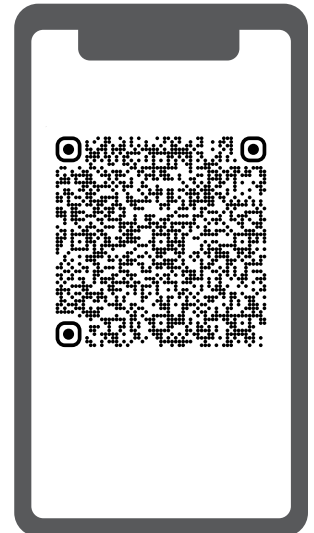

EZBlend™ Chemical Transfer Unit

Service Manual

CTX2V-EZB

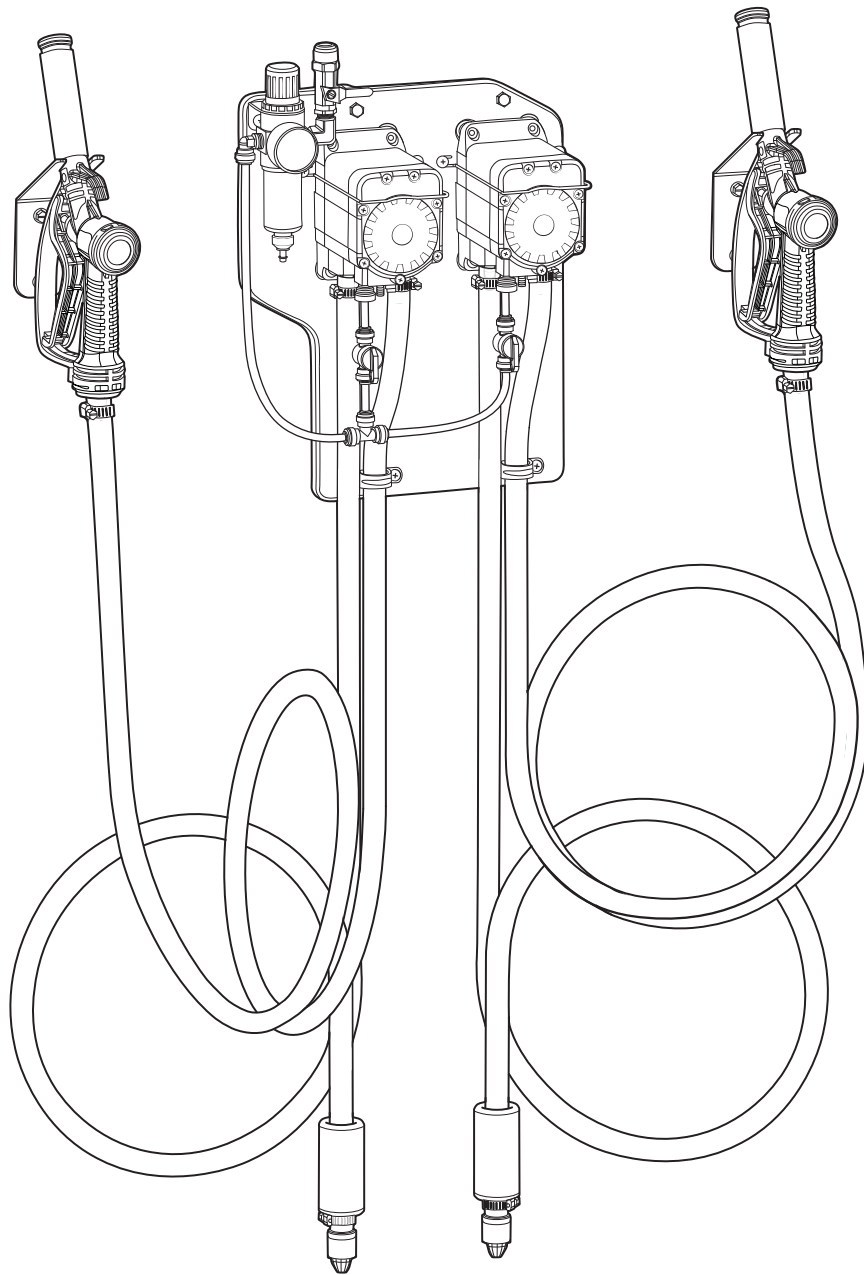

READ ALL INSTRUCTIONS BEFORE USING OR
SERVICING THIS UNIT. KEEP THIS MANUAL IN A
LOCATION THAT IS READILY AVAILABLE TO USERS
AND SERVICE TECHNICIANS.

English (Original Instructions)



Scan this code for
service manual



Safety

WARNING

PEOPLE OR OBJECTS CAN BE HURT OR DAMAGED IF THIS UNIT IS NOT USED CORRECTLY!



Failure to read all the instructions before operating the unit may result in personal injury or death from the improper use or the chemical solution. Anyone handling, operating or using the unit must read and understand the instructions in the manual. The buyer assumes all responsibility for safety and proper use in accordance with the instructions.



Using or servicing the unit without appropriate personal protective equipment (PPE) may result in serious injury such as burns, rashes, eye, throat or lung damage and death. Always wear PPE as indicated in the Safety Data Sheet (SDS) when using or servicing the unit. Protect eyes, skin, and lungs against drifting spray.



Chemical solutions may pose a health risk and death if they contact the skin or eyes, are inhaled or swallowed. Always read and follow all chemical safety precautions and handling instructions provided by the chemical manufacturer and the SDS associated with the chemical solution before using the unit.



Pressure within the equipment may cause an unexpected release of the chemical solution and cause serious injury such as burns, rashes, eye damage, throat or lung damage and death. Always depressurize and clean the unit after each use. Never leave the unit unattended while pressurized.

Using the unit with fluid temperatures above 100°F (37.8°C) may result in scalding, burns, serious injury or death. DO NOT use a solution with a temperature above 100°F (37.8°C).

Operating the unit when damaged or leaking may result in exposure to chemical solutions, serious injury or death. Never use the unit if it is damaged or leaking.

Never point the discharge wand at yourself, another person, or any object you do not want covered in chemical.



Using incoming air pressure exceeding 100 psi (6.9 bar) may result in pressure buildup, explosion, serious injury or death. DO NOT exceed 100 psi (6.9 bar) incoming air pressure when operating the unit.

Use of hydrocarbons and flammable products may result in explosions, fire and serious injury or death. Never use hydrocarbons or flammable products with the unit.



Mixing an alkaline with an acid may result in a chemical reaction. Overheating of the mixture may cause it to splatter caustic compounds or release hazardous fumes, gas and vapors. Always flush the unit with fresh water thoroughly when switching from an alkaline to an acid or an acid to an alkaline.

NOTICE

Servicing or modifying this unit with parts not listed in this manual may cause the unit to operate improperly. Do not use unauthorized parts when servicing the unit.

Use of an air lubricator before the unit may result in diminished performance and damage to the unit. Do not use an air lubricator before the unit.

Moisture in the air lines will damage the pump and diminish the pump life. The air must be filtered, clean, dry and free of moisture. If needed, install an air dryer before the unit.

PROTECT THE ENVIRONMENT



Please dispose of packaging materials, old machine components, and hazardous fluids in an environmentally safe way according to local waste disposal regulations.

Service Guide

WARNING

Performing any maintenance with the unit pressurized and connected to the air supply may result in serious injury or death. Always ensure that the unit has been depressurized and disconnected from the air supply before conducting any maintenance. Servicing or modifying this unit with parts not listed in this manual may cause the unit to operate improperly. Do not use unauthorized parts when servicing the unit.

Maintaining Your Unit

To keep your unit operating properly, periodically perform the following maintenance procedures:

- Inspect the pump for wear and leaks.
 - Inspect all hoses for leaks or excessive wear. Make sure all hose clamps are in good condition and properly secured.
 - Replace the filter located within the air regulator as needed. Clean by unthreading the air regulator bowl from the air regulator.
 - Check the suction line and strainer for debris. Clean as needed.
 - Drain your air compressor tank on a regular basis to help extend pump life. An air source with a high moisture content will accelerate pump wear.
- Note:** If your air source has a high moisture content, install a water separator to the air fitting.

Servicing Your Unit

Most repairs on the unit can be performed with the following tools:

- Crescent wrench
- $\frac{7}{16}$ in. (11 mm) open-ended wrench
- Flat head screwdriver
- #2 Phillips head screwdriver
- Thread seal tape
- Hose cutters
- Knife

Troubleshooting Your Unit

If your unit is not operating properly, try using these troubleshooting tips:

Issue	Solution
Air regulator bowl or air filter has debris such as water, oil, or rust particles	<ul style="list-style-type: none"> • Clean by unthreading the air regulator bowl from the air regulator.
Pump is cycling faster than normal	<ul style="list-style-type: none"> • Verify product is getting to the pump with these steps: <ol style="list-style-type: none"> 1. Inspect suction line foot valve for buildup. 2. Examine the suction hose for holes or cracks. 3. Ensure chemical suction line is fully submerged in the chemical jug. • If these items are confirmed, the pump may need to be replaced.
Pump is cycling slower than normal	<ul style="list-style-type: none"> • Verify that the unit is receiving proper air supply. Air supply should read at 50 psi (3.4 bar). • Restriction on the outlet side of the unit may cause issues. Inspect outlet hose and fittings for build up. Clean or replace as needed. • Confirm air inlet valve is open completely. • Pump may need to be replaced.
Air passes through the pump without cycling	<ul style="list-style-type: none"> • The pump needs to be replaced.
The unit operates at a reduced pressure	<ul style="list-style-type: none"> • Check suction line and strainer for debris or damage. Clean or replace as needed. To prevent damage to the unit, the strainer must always be used. • Check the air compressor supplying the unit. If the pressure is less than 40 psi (2.8 bar), turn off the unit until the compressor can catch up. • If the air supply is 50 psi (3.4 bar) or above, check the air gauge, which should read near 50 psi (3.4 bar). If the air gauge reads more or less than 50 psi (3.4 bar), adjust the pressure by turning the knob on the top of the air regulator.

EZBlend™ Chemical Transfer Unit

CTX2V-EZB:
EZBlend™ Sterilex dispenser - chemical transfer unit -
exposed pump - 2 product - for Viton pumps

Item number		Description
1	R25	Air regulator - two ¼ in. FPT ports - two ⅜ in. FPT ports - includes filter and bowl
2	QFEL14P	Fixed elbow ¼ in. tube x ¼ in. MPT - polypropylene
3	AG100	Air gauge - ⅜ in. NPT - 100 PSI dry model
4	QF14PAF	Quick fit - ¼ MPT pump air fitting
5	QFSOV14	Shut off valve ¼ in. tube - polypropylene
6	TB14BL-PU	¼ in. od blue polyurethane tubing - available per ft.
7	QFT14	Union tee ¼ in. tube - polypropylene
8	H12BL-F	½ in. id blue hose - hybrid TPE - available per ft.
9	QF1438	Quick fit - ¼ MPT x ⅜ od tube - polypropylene
10	BVB14	Air inlet valve - ¼ in. FPT x ¼ in. FPT
11	SEL14M	Stainless elbow ¼ in. MPT x ¼ in. MPT
12	S1012-HL	10-16 x ½ in. screw - stainless - hi lo
13	BRKT-P56	Pump bracket - stainless steel
14	P56V	Pump with Viton seals - includes hose barbs, air fitting, and exhaust barb
15	CLMP12	Clamp for ½ in. hose - PVC
16	H12GN-F	½ in. id green hose - hybrid TPE - available per ft.

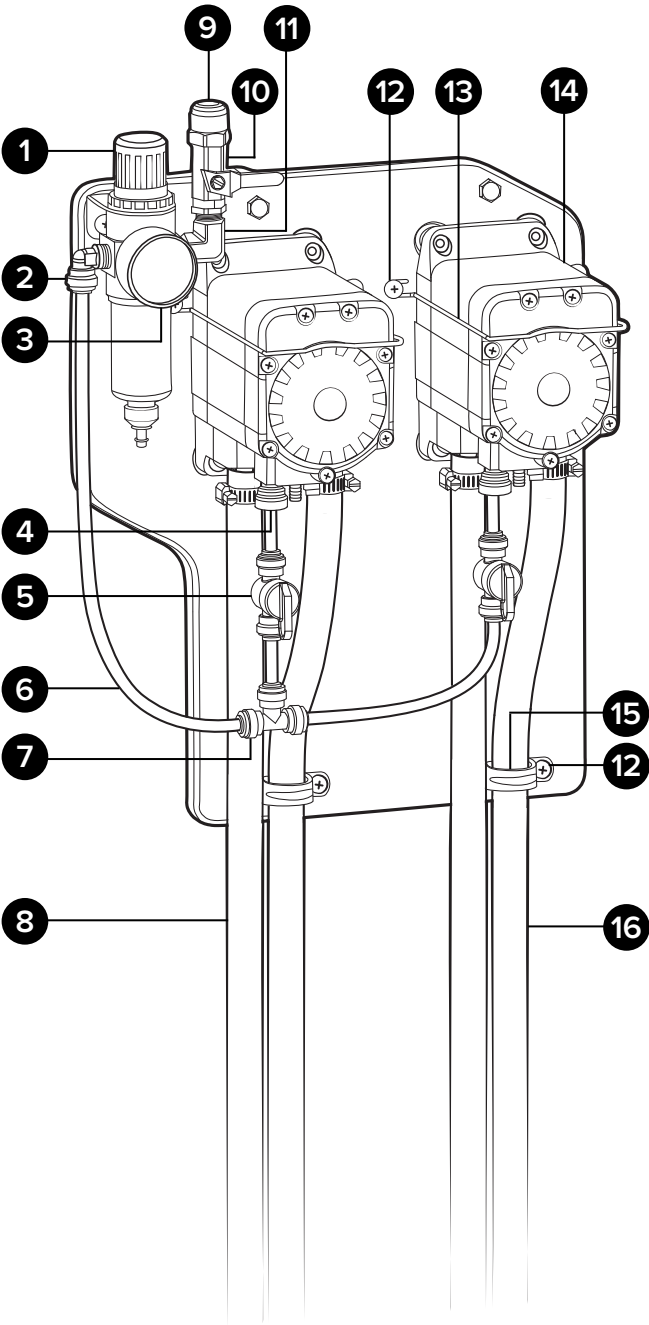

Suction Assembly

SHA12GN-8V:
Suction assembly for EZBlend™ chemical transfer units - includes suction valve, green hose, weight, and pump hose barb - for Viton pumps

Item number		Description
1	HB5638V	Hose barb for P56V pump - Viton o-ring
2	H12GN-F	½ in. id green hose - hybrid TPE - available per ft.
3	SHW3	3 in. long coated weight
4	SSC12	Stainless screw band clamp for ½ in. hose
5	FV2	Foot valve - Viton - black

Green hose

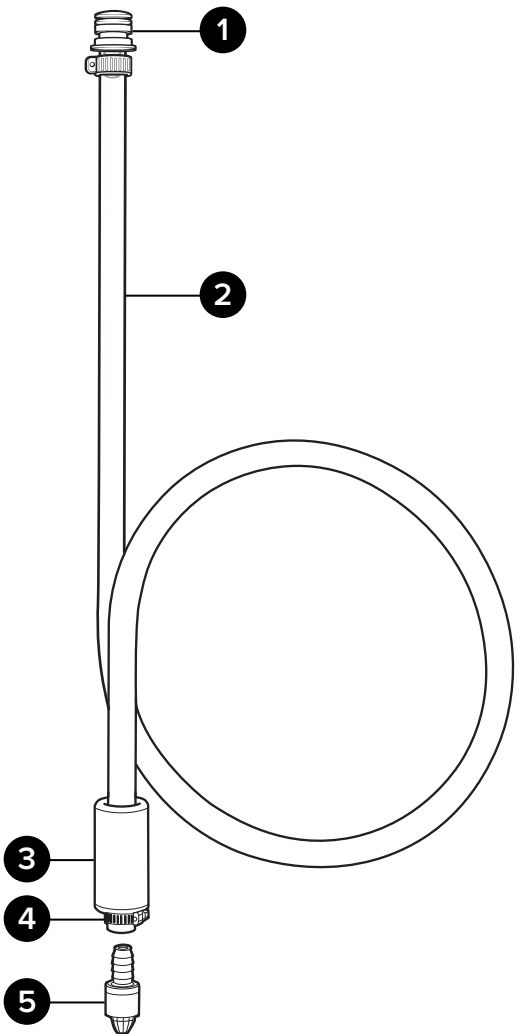
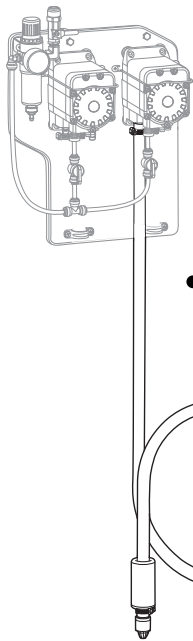

SHA12GN-8V

Suction Assembly

SHA12BL-8V:
Suction assembly for EZBlend™ chemical transfer units - includes suction valve, blue hose, weight, and pump hose barb - for Viton pumps

Item number		Description
1	HB5638V	Hose barb for P56V pump - Viton o-ring
2	H12BL-F	½ in. id blue hose - hybrid TPE - available per ft.
3	SHW3	3 in. long coated weight
4	SSC12	Stainless screw band clamp for ½ in. hose
5	FV2	Foot valve - Viton - black

Blue hose

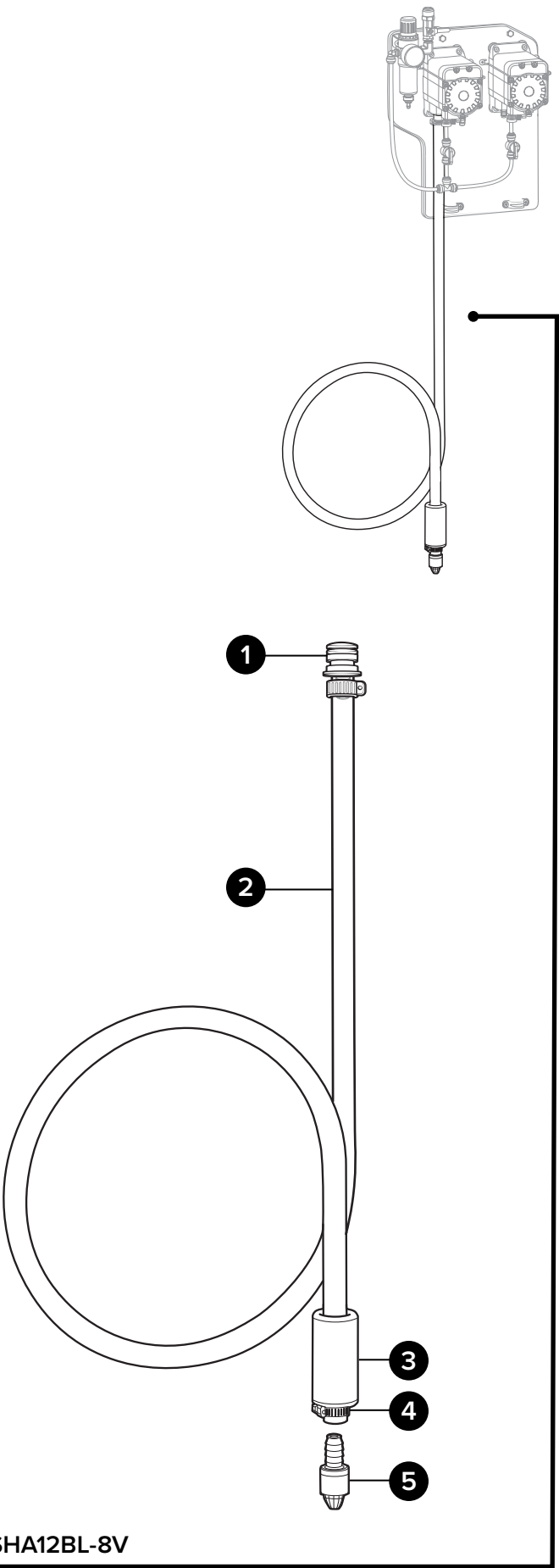

Discharge Assembly

BRKTA-PFG:

Bracket assembly for poly fill gun - includes bolt, anchor, and bracket

Item number		Description
1	WMS14A	#14 x 1 ¼ in. wall mount screw anchor - plastic - 5⁄16 in. drill size
2	BRKT-PFG	Mounting bracket for poly fill gun
3	WMS14	#14 x 1 ¼ in. wall mount screw - stainless - hex head slotted

PFGA-WH-H12GN-8-HB56V:

Discharge assembly - includes fill gun, green hose, hose barb, and screw band clamps - for Viton pumps

Item number		Description
4	HB5638V	Hose barb for P56V pump - Viton o-ring
5	PFG12HB	White fill gun - polypropylene - ½ in. hose barb - Hastelloy spring - Viton seals
6	SSC12	Stainless screw band clamp for ½ in. hose
7	H12GN-F	½ in. id green hose - hybrid TPE - available per ft.

Green hose

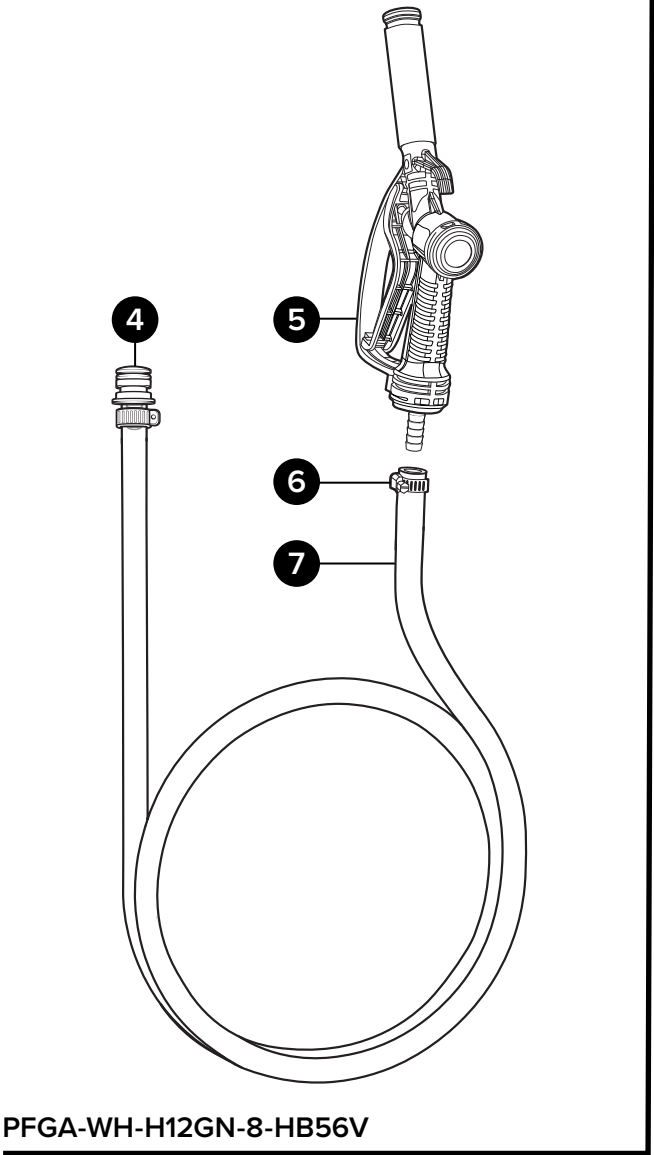
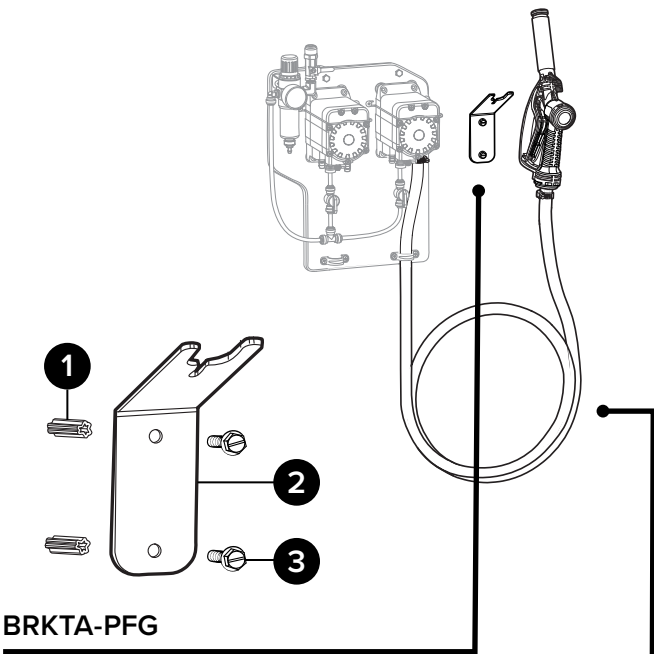

Discharge Assembly

PFGA-WH-H12BL-8-HB56V:

Discharge assembly - includes fill gun, blue hose, hose barb, and screw band clamps - for Viton pumps

Item number		Description
1	PFG12HB	White fill gun - polypropylene - ½ in. hose barb - Hastelloy spring - Viton seals
2	SSC12	Stainless screw band clamp for ½ in. hose
3	H12BL-F	½ in. id blue hose - hybrid TPE - available per ft.
4	HB5638V	Hose barb for P56V pump - Viton o-ring

Blue hose

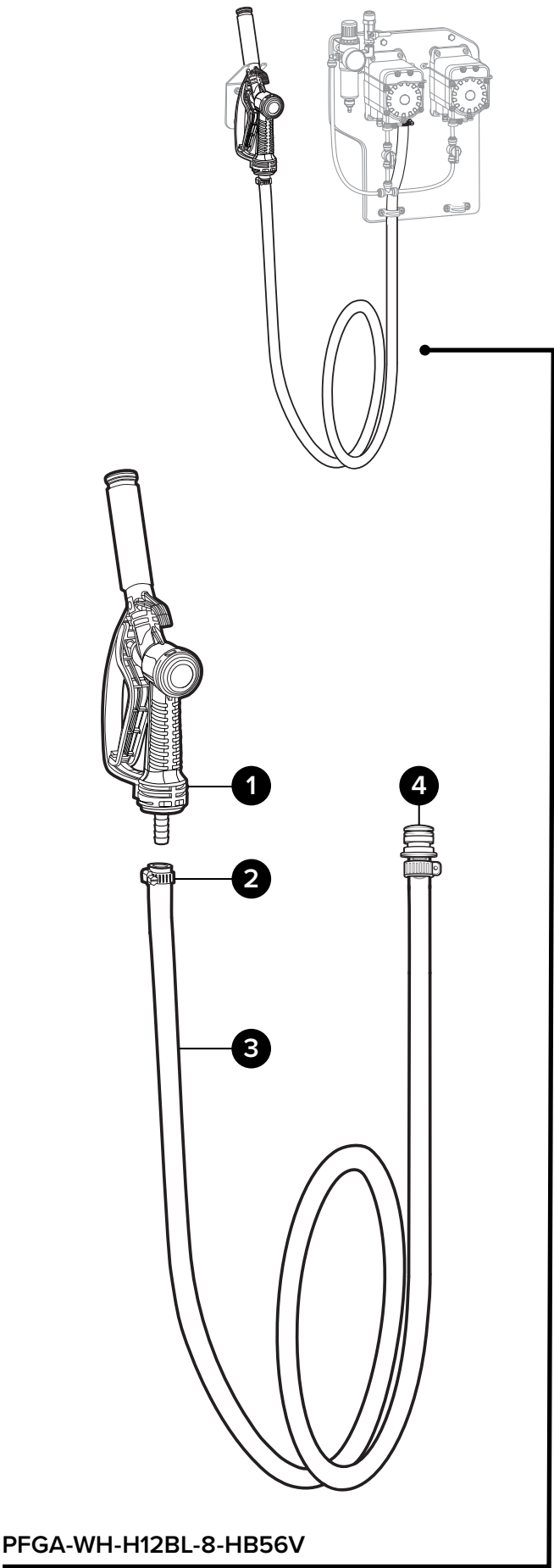

Regulator Assembly

RGA-R25-CTX:

Air regulator assembly for chemical transfer units - includes air gauge, quick fit, hose, air inlet valve, bracket, and elbows

Item number		Description
1	REGBRKT	A33-82 bracket, MTG
2	R25	Air regulator - two ¼ in. FPT ports - two ⅛ in. FPT ports - includes filter and bowl
3	BVB14	Air inlet valve - ¼ in. FPT x ¼ in. FPT
4	QF1438	Quick fit - ¼ MPT x ¾ od tube - polypropylene
5	SEL14M	Stainless elbow ¼ in. MPT x ¼ in. MPT
6	AG100	Air gauge - ⅛ in. NPT - 100 PSI dry model
7	S1012-HL	10-16 x ½ in. screw - stainless - hi lo
8	QFEL14P	Fixed elbow ¼ in. tube x ¼ in. MPT - polypropylene
9	TB14BL-PU	¼ in. od blue polyurethane tubing - available per ft.

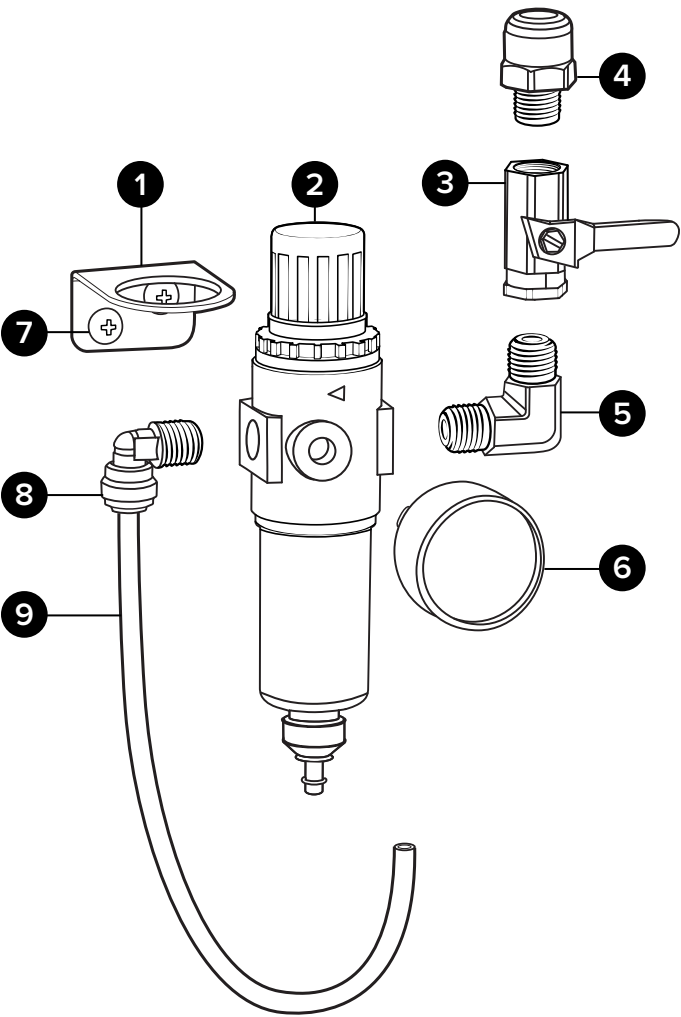
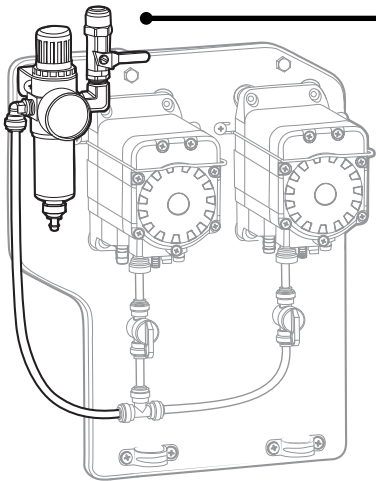

RGA-R25-CTX