

---

# USER MANUAL

**MODEL NUMBER:  
GI-10N  
GI-10NK  
GI-10NV  
AND RELATED UNITS**

**10 Gallon Air Operated Portable Gel  
Equipment**

---

**English (Original Instructions)**

---

## READ ALL INSTRUCTIONS BEFORE OPERATING EQUIPMENT



# WARNING



**Read this manual completely and understand the machine before operating or servicing it.**

- Read all instructions before installing or operating unit.
- Always wear appropriate personal protective equipment (PPE) when operating or servicing unit.
- Always follow all chemical safety precautions and handling instructions provided by the chemical manufacturer and Safety Data Sheet (SDS).
- Never point the discharge wand at yourself, another person, or any object you do not want covered in chemical.
- Always depressurize unit after use (as described in the After Use Instructions). Always store unit depressurized, with the discharge ball valve in the closed position.
- Do not exceed an incoming air pressure of 100 psi (7 bar).
- Do not exceed a fluid temperature of 100°F (37°C).
- Only use clean and dry air. Air must be filtered and free of moisture or pump life will be diminished. If needed, install an air dryer before unit.
- Do not use an air lubricator before the unit.

### PROTECT THE ENVIRONMENT

Please dispose of packaging materials, old machine components, and hazardous fluids in an environmentally safe way according to local waste disposal regulations.



Always remember to recycle.

\*Specifications and parts are subject to change without notice.

## READ ALL INSTRUCTIONS BEFORE OPERATING EQUIPMENT

OPTIONS	
	Pump Seal Material
GI-10N	Santoprene (standard)
	Viton ( <b>V</b> )
	Kalrez ( <b>K</b> )
Add bold option codes to item number as shown. For standard options, no option code is needed.	
Examples:	
<ul style="list-style-type: none"> <li>GI-10N (standard unit with Santoprene pump seals)</li> <li>GI-10NV (unit with Viton pump seals)</li> </ul>	

REQUIREMENTS	
Compressed air requirements	40-80 psi (3-5 bar) with 2 cfm (28.3 l/min)
Liquid temperature range	40-100°F (4.4-37°C)
Chemical compatibility	Chemical products used with this equipment must be formulated for this type of application and compatible with unit materials and pump seals. For more information on chemical compatibility, consult the manufacturer or MSDS for your product or contact our customer service department.

SPECIFICATIONS	
Power type	Compressed air
Chemical pickup type	Draws from pre-mixed solution
Number of products unit can draw from	One product
Suction line length/diameter	3/8 in. (9.5 mm) inside diameter
Capacity	12.5 gallons (47.3 liters)
Discharge hose diameter/length	30 ft. (9 m) hose, with 1/2 in. (12.7 mm) inside diameter
Discharge wand/tip type	10 in. (50.8 cm) poly wand with fan tip and ball valve (Spray tips included: ST1510, ST2508, and ST4008)
Output distance	6-10 ft. (1.8-3 m) (Varies due to viscosity of product)
Output volume	0.5-1 gal/min (1.89-3.79 l/min) (Varies due to viscosity of product and fan tip size)
Flow rate*	2 gal/min (7.6 l/min) (Varies based and spray tip used)
Pump seals	Santoprene, Viton, or Kalrez
Wheel type	Two 10 inch non-marking wheels

\*Dilution rates and flow rates given are based on chemical with viscosity of water and factory air pressure settings.

## READ ALL INSTRUCTIONS BEFORE OPERATING EQUIPMENT

### Operation Instructions

Wearing all PPE and observing all safety precautions dictated by the SDS for your chemical:

1. Fill the tank with the desired gel product.
2. With the discharge ball valve in the closed position, connect an appropriate compressed air line into the air inlet fitting.
3. Open the discharge ball valve to begin dispensing gel chemical.

### After Use Instructions:

1. Thoroughly flush the unit with fresh water.
2. Disconnect the air line from the air fitting and relieve any pressure remaining in the system by opening the discharge ball valve.
3. Close the ball valve after all pressure has been relieved from the system. Store the unit with the discharge ball valve in the closed position.

### Maintenance Instructions:

To keep your portable unit operating properly, periodically perform the following maintenance procedures:

- Check the air pump for wear and leaks.
- Inspect hoses for leaks or excessive wear. Make sure all hose clamps are in good condition and properly secured.
- Replace filter in regulator as needed.
- Check the suction tube and screen for debris and clean as needed.
- Drain compressor tank on a regular basis to ensure proper operation of pump.

### Troubleshooting Instructions:

- Check to ensure that the discharge hose is uncoiled properly, and that there are no kinks that could obstruct fluid flow.
- Check the air regulator bowl and air filter for debris such as water, oil, or rust particles. Clean by unthreading the air regulator bowl from the air regulator.
- Check the strainer for debris or other blockages, and clean as needed. Replace strainer if damaged. Strainer must be used.
- If air passes through the pump without cycling, the pump needs to be replaced.
- Check for proper air pressure on the air gauge. The air regulator (R25) is factory set at 50 psi (3.4 bar). Operating range is 40 to 80 PSI (3 to 5 bar) with 2 CFM (56.6 l/min).
- If the unit operates at a reduced pressure:
  - Check the air compressor supplying the unit. If the pressure is less than 40 psi, turn the unit off until the compressor can catch up.
  - If the air supply is 50 psi (3.4 bar) or above, check the air gauge, which should read near 50 psi (3.4 bar). If the air gauge reads more or less than 50 psi (3.4 bar), adjust the pressure by turning the knob on the top of the air regulator.

## READ ALL INSTRUCTIONS BEFORE OPERATING EQUIPMENT

### TANK ASSEMBLY ITEM NUMBER: TNKA-10N-BK

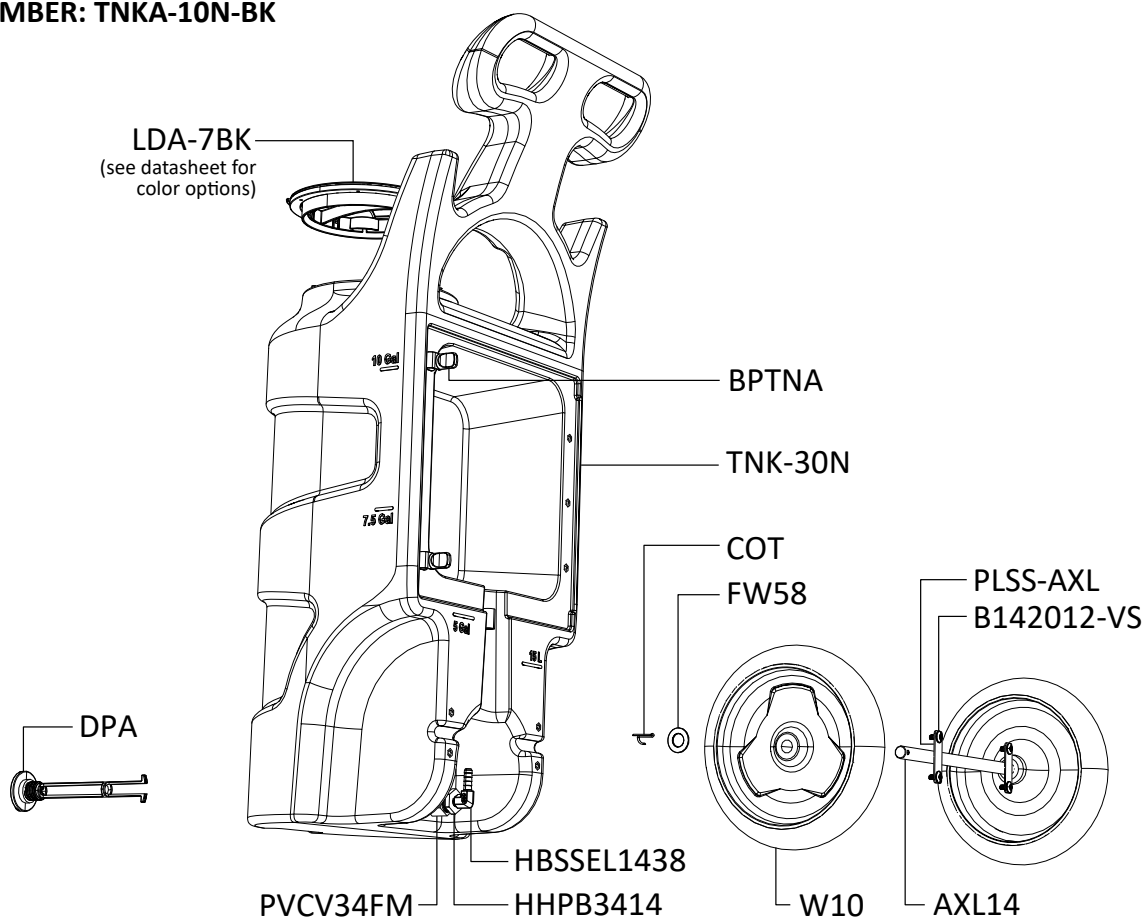

### DISCHARGE WAND

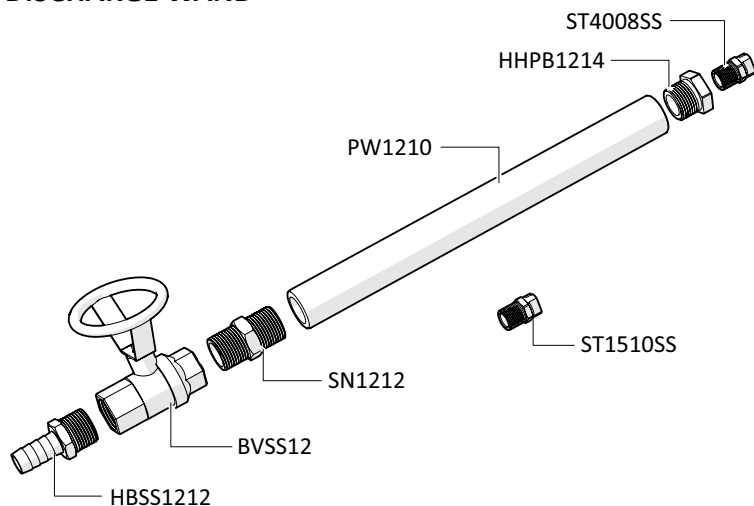

### DISCHARGE HOSE ASSEMBLY ITEM NUMBER: HA12BL-30

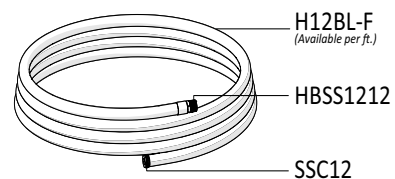

### ANTI-KINK SPRING WITH RETAINING PIN ITEM NUMBER: AKSS12

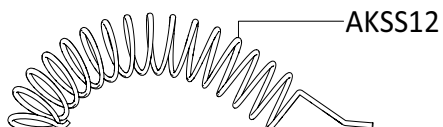

## READ ALL INSTRUCTIONS BEFORE OPERATING EQUIPMENT

### PLATE ASSEMBLY

#### Plate - Inside View

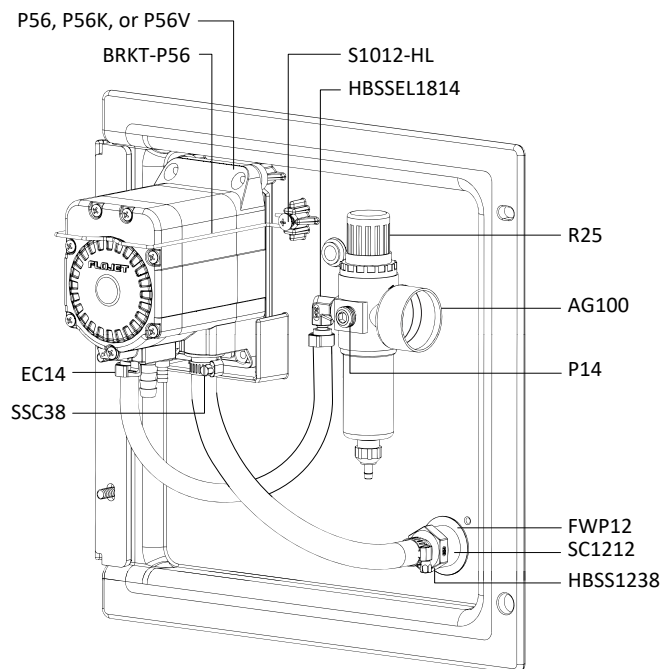

#### Plate - Back View

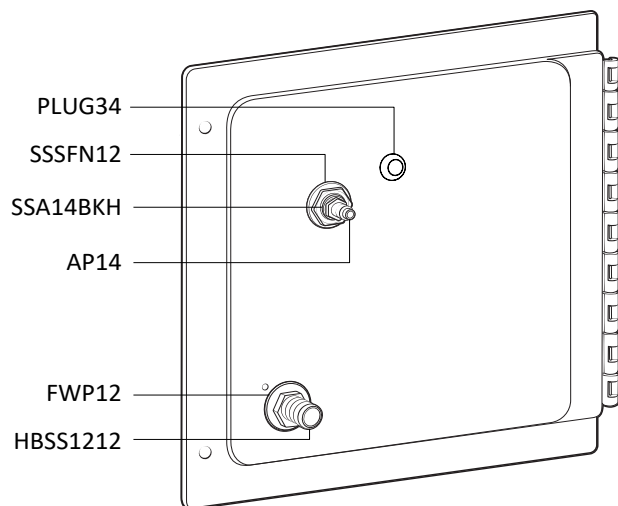

### SUCTION ASSEMBLY

ITEM NUMBER (Santoprene pump): **SCTNA-PF**

ITEM NUMBER (Kalrez pump): **SCTNA-PFK**

ITEM NUMBER (Viton pump): **SCTNA-PFV**

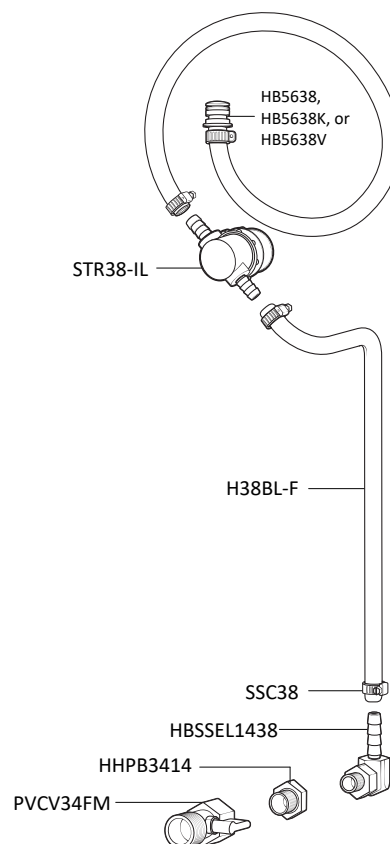

### OPTIONAL COMPONENTS

**WATER SEPARATOR ASSEMBLY**  
ITEM NUMBER: **WSA-20CFM**

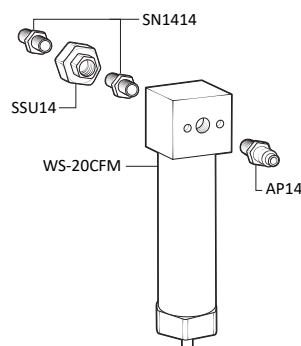

**30 ft (9 m) AIR HOSE ASSEMBLY**  
ITEM NUMBER: **AH30**

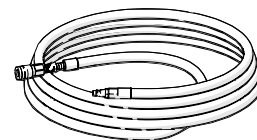

# READ ALL INSTRUCTIONS BEFORE OPERATING EQUIPMENT

ITEM NUMBER	DESCRIPTION		
AG100	AIR GAUGE - ½ IN. NPT - 100 PSI DRY MODEL	P56V	PUMP WITH VITON SEALS - INCLUDES HOSE BARBS, AIR FITTING, AND EXHAUST BARB
AH30	30 FT AIR HOSE W/ QUICK CONNECT FITTINGS	20756103B	POLYPRO G57 AIR PORT X HB STRAIGHT, W/ VITON O-RING
AP14	AIR FITTING ¼ MPT X PLUG-NICKEL-PLATED BRASS	HB14P	¼ IN. BRASS HB AIR FITTING /G57/P56
AXL14	AXLE-STAINLESS-0.625 DIA X 14.5 IN.	HB5638	HOSE BARB FOR P56 PUMP - EPDM O-RING
B142012-VS	¼-20 X ½ IN. BOLT - STAINLESS - TRUSS HEAD PHILLIPS - VIBRA-SEAL	HB5638K	HOSE BARB FOR P56K PUMP - KALREZ O-RING
B103234	10-32 X 3/4 PHIL TRUSS MACH SCR 18-8	HB5638V	HOSE BARB FOR P56V PUMP - VITON O-RING
BPTNA	BACK PLATE THUMB NUT ASSEMBLY - INCLUDES BOLT, THUMB NUT, AND TETHER	PLPF	PORTABLE FOAMER BACK PLATE W/ HINGE AND HOLES
BST14201125-VS	¼-20 SET BOLT - 1.125 IN. LONG - VIBRA-SEAL	PLPF-PIN	302 STAINLESS PORTABLE PLATE HINGE PIN
TN1420	¼-20 THUMB NUT - BRASS INSERT - ASSEMBLED WITH TETHER	PLSS-AXL	AXLE PLATE - STAINLESS - 2.5 IN. X 1 IN. - 2 HOLES
BRKT-P56	PUMP BRACKET- STAINLESS STEEL	PLUG34	TUBING PLUG ¾ ( FITS 1¼ HOLE)
BVB14	AIR INLET VALVE - VA BRS 025-4F4F-BT, NICKEL	PVCV34FM	PVC VALVE ¼ IN. FPT X ¼ IN. MPT
BVSS12	STAINLESS BALL VALVE-½ IN. NPT	PW1210	½ IN. FPT X ½ IN. FPT - 10 IN. LONG - BLACK POLYPRO
COT	COTTER PIN-STAINLESS-½ IN. X 1 IN.	R25	AIR REGULATOR - TWO ¼ IN. FPT PORTS - TWO ¼ IN. FPT PORTS - INCLUDES FILTER AND BOWL
LDA-7BK	LID ASSEMBLY - INCLUDES 7 IN. BLACK LID, LID FLANGE, HINGE PIN, AND MOUNTING SCREWS	S1012-HL	10-16 X ½ IN. SCREW-STAINLESS-HI LO
LD-7BK-LID	7 IN. CAP - POLYETHYLENE - BLACK	SN1212	1/2in HEX STAINLESS STEEL NIPPLE
LD-7BK-FLNG	7 IN. LID FLANGE - POLYETHYLENE - BLACK	SN1414	STAINLESS HEX NIPPLE ¼ MPT X ¼ MPT
LD-PIN	HINGE PIN FOR 7 IN. LID AND FLANGE	SSA14BKH	BULKHEAD ADAPTER - STAINLESS - ¼ NPT X ¼ NPSM
DPA	DRAIN PLUG ASSEMBLY - INCLUDES GASKET	SSC12	STAINLESS SCREW BAND CLAMP FOR ½ IN. HOSE
EC12	OETIKER EAR CLAMP FOR ½ IN. HOSE	SSC38	STAINLESS SCREW BAND CLAMP FOR ¾ IN. HOSE
EC14	OETIKER EAR CLAMP FOR ¼ IN. HOSE	ST1510SS	VEEJET NOZZLE, S.S. 1510
F12SS	STAINLESS .875 ID FERRULE FOR 1/2 INCH HOSE	ST4008SS	VEEJET NOZZLE, S.S. 4008
FW58	FLAT WASHER FOR ¾ IN. PIPE - STAINLESS - 0.687 ID X 1.5 OD X 0.07 THK	STR38-IL	IN LINE STRAINER 3/8 BARB 20 MESH 304 STAINLESS EDPM GSKT
FWP12	¾ ID X 1.5 OD X 0.05 THK SSFW	SSU14	STAINLESS STEEL UNION- ¼ INCH FP
H12BL-F	½ INCH BLUE HOSE-HYBRID TPE-AVAILABLE PER FT.	TNK-10N	10 GALLON NATURAL TANK
H14BL-F	¼ INCH BLUE HOSE-HYBRID TPE-AVAILABLE PER FT.	W10	NONMARKING WHEEL FOR PORTABLE UNITS
H38BL-F	¾ INCH BLUE HOSE-HYBRID TPE-AVAILABLE PER FT.	WS-20CFM	WATER SEPARATOR - 20 CFM - ¼ IN. FPT PORTS
HBSS1212	STAINLESS HOSE BARB ½ MPT X ½ BARB		
HBSS1238	STAINLESS HOSE BARB ½ MPT X ¾ BARB		
HBSSSEL1438	STAINLESS HOSE BARB ¼ MPT X ¾ BARB ELBOW		
HBSSSEL1814	STAINLESS HOSE BARB ¾ MPT X ¼ BARB ELBOW		
HHPB1214	HEX HEAD POLY REDUCER BUSHING ½ IN. X ¼ IN.		
HHPB3414	HEX HEAD POLY BUSHING ¾ MPT X ¼ FPT		
P14	COUNTERSUNK PLUG-HEXAGON ¼		
P56	PUMP WITH SANTOPRENE SEALS - INCLUDES HOSE BARBS, AIR FITTING, AND EXHAUST BARB		
P56K	PUMP WITH KALREZ SEALS - INCLUDES HOSE BARBS, AIR FITTING, AND EXHAUST BARB		