USER MANUAL

MODEL NUMBER:

MU-10N-3

MU-10NK-3

MU-10NV-3

AND RELATED UNITS

**10 Gallon Air Operated Portable Mist
Equipment**

English (Original Instructions)

READ ALL INSTRUCTIONS BEFORE OPERATING EQUIPMENT



WARNING



Read this manual completely and understand the machine before operating or servicing it.

- Read all instructions before installing or operating unit.
- Always wear appropriate personal protective equipment (PPE) when operating or servicing unit.
- Follow all chemical safety precautions and handling instructions provided by the chemical manufacturer and Safety Data Sheet (SDS).
- Do not exceed an incoming air pressure of 100 psi (7 bar).
- Do not exceed a fluid temperature of 100°F (37°C).
- Only use clean and dry air. Air must be filtered and free of moisture or pump life will be diminished. If needed, install an air dryer before unit.
- Do not use air lubricator before the unit.

PROTECT THE ENVIRONMENT

Please dispose of packaging materials, old machine components, and hazardous fluids in an environmentally safe way according to local waste disposal regulations.



Always remember to recycle.

Specifications and parts are subject to change without notice.

Specifications:

Mist mast height range: 3.5 to 8.5 ft
(1 m to 2.6 m) approximately
Liquid Temperature 40°F to 100°F (4.4°C to 37°C)
Droplet size: 20 microns at 50 psi

1 liter of solution will cover approximately 1000 cubic feet (up to system max of 38,000 cubic feet).*

A full tank of solution will supply the unit for approximately 1 hour.*

*NOTE: Area covered and run time may vary based on humidity, air flow, and product used

Dimensions and Weight:

Length: 21 in (534 mm) approximately
Width: 20 in (508 mm) approximately
Height: 47 in (1194 mm) approximately
Weight (empty): 42 lbs (19 kg) approximately

Requirements:

Air pressure required: 50 psi (3.4 bar)

Air volume required: 9 CFM at 50 psi (254.9 l/min at 3.4 bar)

Chemical Requirements: Follow all instructions from chemical manufacturer and Safety Data Sheet (SDS).

Air Operated Double Diaphragm Pump Models Offered:

P56: Polypropylene body with Santoprene diaphragm

P56V: Polypropylene body with Viton diaphragm

P56K: Polypropylene body with Kalrez diaphragm

READ ALL INSTRUCTIONS BEFORE OPERATING EQUIPMENT

Assembly Instructions

1. Remove all components from packaging.
2. Attach the mist nozzle assembly to the top of the mist mast using the screw provided in the parts package. The mist nozzles should point upwards.
3. Push one end of the red tube into the fitting labeled “RED” on the unit’s back plate.
4. Push one end of the blue tube into the fitting labeled “BLUE” on the unit’s back plate.
5. Connect the other ends of the red and blue tubes to the mist nozzle assembly. Locate the two tee fittings with an open port and connect the solution line (red) to the liquid tee and the air line (blue) to the air tee. To determine which tee is air and which is liquid, trace the clear tubing from the tee to one of the mist nozzles – on the body of the nozzle, the air line is labeled “AIR” and the liquid line is labeled “LIQ.” **Note:** Make sure to insert the tubing all the way into the fittings to ensure proper connection.

Operation Instructions

Wearing all PPE and observing all safety precautions dictated by the SDS for your chemical:

1. Fill the tank with the desired amount of solution.
2. Place the unit in the area to be misted.
3. Adjust the mist mast to the desired height. To change the height, loosen the collar screws, move the mast up or down as needed, then retighten the collar screws to secure the mast. **Caution:** To prevent injury from collapsing mast, always support the mast when adjusting height. Always make sure the collar screws are tight and secure before letting go of the mast.
4. Ensure the air supply valve is in the closed position, and connect a compressed air line to the air inlet fitting.
5. Open the air supply valve to activate the unit.
6. Evacuate the area.
7. After the unit has stopped misting, observe all appropriate safety precautions before reentering area. Close the air supply valve and disconnect the compressed air line from the unit.
8. Before moving the unit, always lower the mist mast completely and secure it in the lowest position.

READ ALL INSTRUCTIONS BEFORE OPERATING EQUIPMENT

TANK ASSEMBLY ITEM NUMBER: TNKA-10N-IN

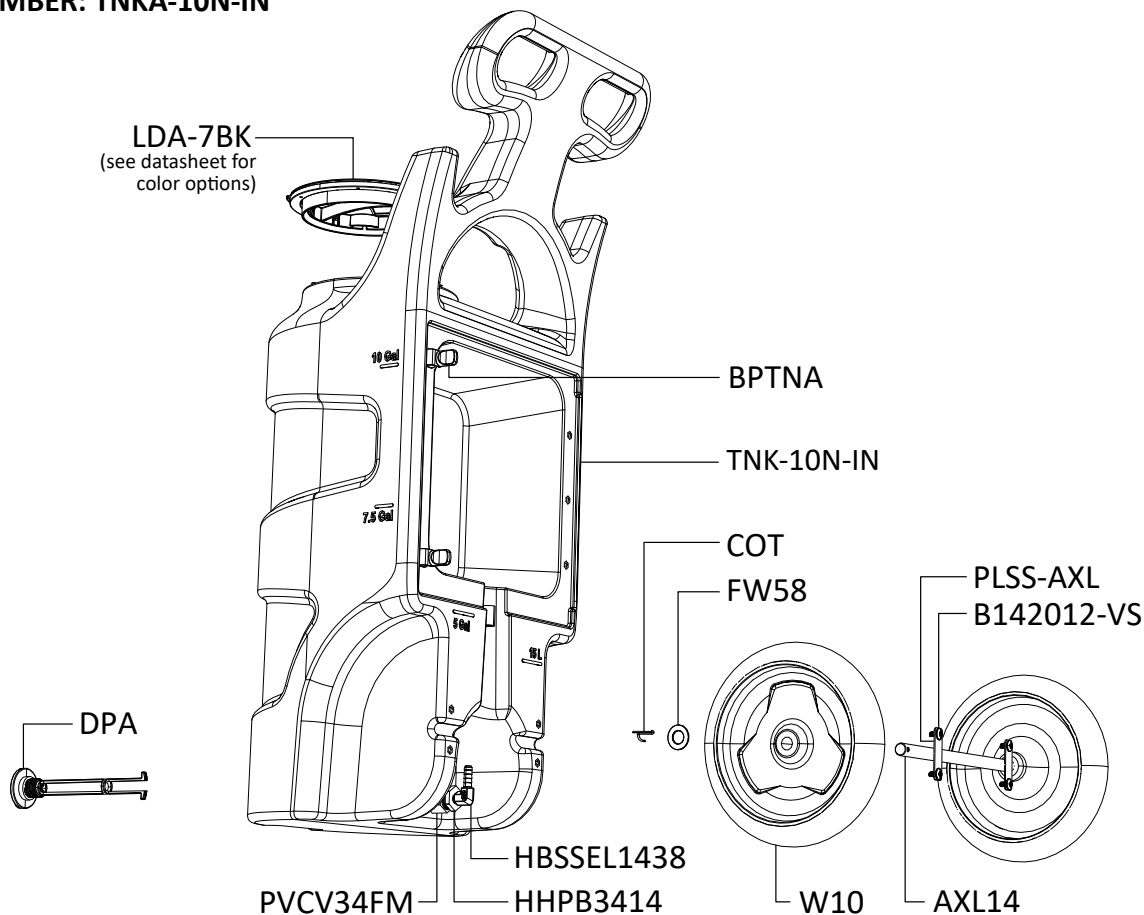

OPTIONAL COMPONENTS

AIR HOSE ASSEMBLY ITEM NUMBER: AH30

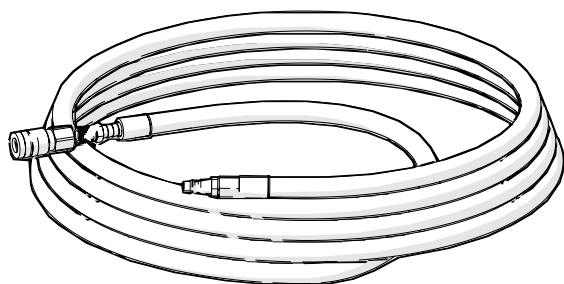

WATER SEPARATOR ITEM NUMBER: WSA-20CFM

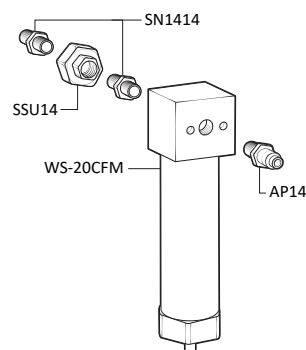

READ ALL INSTRUCTIONS BEFORE OPERATING EQUIPMENT

Plate - Inside View

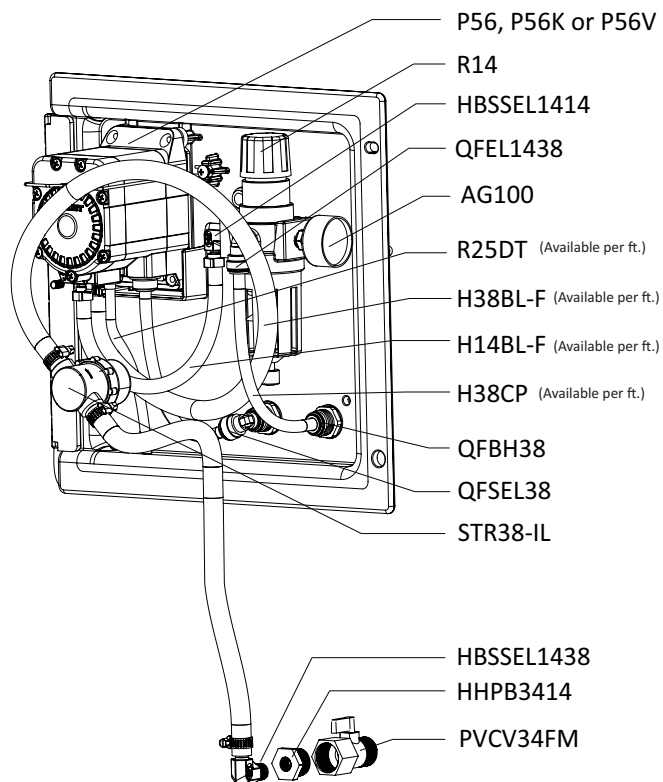
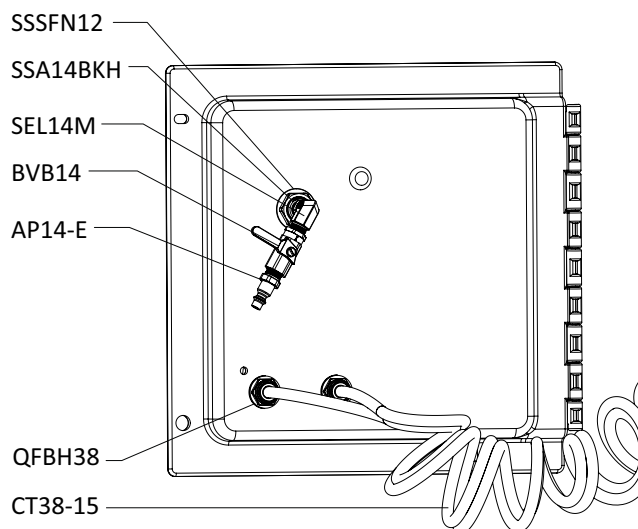
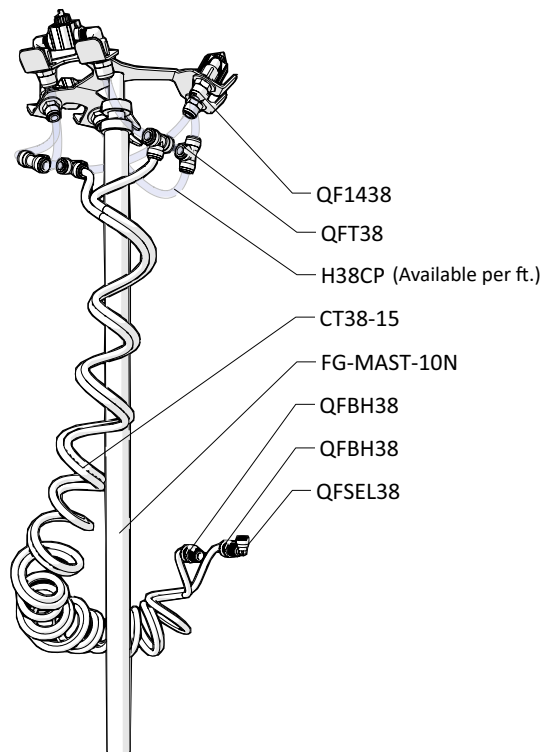

Plate - Back View



Mist Mast Assembly



Mist Mast - Top View

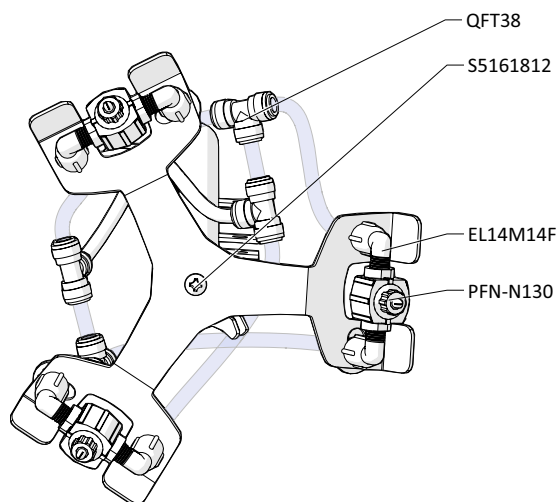

READ ALL INSTRUCTIONS BEFORE OPERATING EQUIPMENT

ITEM NUMBER	DESCRIPTION
3NA-N130	FG-10N-3 TOP BRACKET ASSEMBLY WITH 3 PFN-N130 NOZZLES
3NA-N130-MAST	FG-10N-3 COMPLETE MAST ASSEMBLY
AG100	AIR GAUGE - ½ IN. NPT - 100 PSI DRY MODEL
AH30	30 FT AIR HOSE W/ QUICK CONNECT FITTINGS
AP14-E	AIR FITTING 1/4 MPT X PLUG-NICKEL-PLATED BRASS-FOR EUROPE
AXL14	AXLE-STAINLESS-0.625 DIA X 14.5 IN
B142012-VS	¼-20 X ½ IN. BOLT - STAINLESS - TRUSS HEAD PHILLIPS - VIBRA-SEAL
B103234	10-32 X 3/4 PHIL TRUSS MACH SCR 18-8
BPTNA	BACK PLATE THUMB NUT ASSEMBLY - INCLUDES BOLT, THUMB NUT, AND TETHER
<i>BST14201125-VS</i>	¼-20 SET BOLT - 1.125 IN. LONG - VIBRA-SEAL
<i>TN1420</i>	¼-20 THUMB NUT - BRASS INSERT - ASSEMBLED WITH TETHER
BRKT-P56	PUMP BRACKET- STAINLESS STEEL
BVB14	AIR INLET VALVE - VA BRS 025-4F4F-BT, NICKEL
BVSS12	STAINLESS BALL VALVE-½ IN. NPT
COT	COTTER PIN-STAINLESS-½ IN. X 1 IN.
CT38-15	3/8 INCH X 15 FT COILED BLACK AND CLEAR TUBING-POLY URETHANE
LDA-7BK	LID ASSEMBLY - INCLUDES 7 IN. BLACK LID, LID FLANGE, HINGE PIN, AND MOUNTING SCREWS
<i>LD-7BK-LID</i>	7 IN. CAP - POLYETHYLENE - BLACK
<i>LD-7BK-FLNG</i>	7 IN. LID FLANGE - POLYETHYLENE - BLACK
<i>LD-PIN</i>	HINGE PIN FOR 7 IN. LID AND FLANGE
DPA	DRAIN PLUG ASSEMBLY - INCLUDES GASKET
EC14	OETIKER EAR CLAMP FOR ¼ IN. HOSE
EL14M14F	¼ FEM PIPE X ¼ M PIPE ELBOW
FG-MAST-10N	FOG MAST FOR TANK-10N-IN
FW58	FLAT WASHER FOR ¾ IN. PIPE - STAINLESS - 0.687 ID X 1.5 OD X 0.07 THK
FWLG14	.569 ID X 1.28 OD X .08 THICK FLAT WASHER SS 18-8
H14BL-F	¼ INCH BLUE HOSE-HYBRID TPE-AVAILABLE PER FT.
H38BL-F	¾ INCH BLUE HOSE-HYBRID TPE-AVAILABLE PER FT.
H38CP	¾ INCH OD POLYETHYLENE TUBING - NATURAL
HBSSEL1414	STAINLESS HOSE BARB ¼ MPT X ¼ BARB ELBOW
HBSSEL1438	STAINLESS HOSE BARB ¼ MPT X ¾ BARB ELBOW
HHSB1418	HEX HEAD BUSHING ¼ MPT X ¼ FPT
HHPB3414	HEX HEAD POLY BUSHING ¼ MPT X ¼ FPT
P56	PUMP WITH SANTOPRENE SEALS - INCLUDES HOSE BARBS, AIR FITTING, AND EXHAUST BARB
P56K	PUMP WITH KALREZ SEALS - INCLUDES HOSE BARBS, AIR FITTING, AND EXHAUST BARB

P56V	PUMP WITH VITON SEALS - INCLUDES HOSE BARBS, AIR FITTING, AND EXHAUST BARB
<i>20756103B</i>	<i>POLYPRO G57 AIR PORT X HB STRAIGHT, W/ VITON O-RING</i>
<i>HB14P</i>	<i>1/4IN BRASS HB AIR FITTING /G57/P56</i>
<i>HB5638</i>	<i>HOSE BARB FOR P56 PUMP</i>
<i>HB5638K</i>	<i>HOSE BARB FOR P56K PUMP</i>
<i>HB5638V</i>	<i>HOSE BARB FOR P56V PUMP</i>
<i>QF5638</i>	<i>¾ IN. QF PUMP FITTING / G57</i>
PFN-N130	PNEUMATIC FOG NOZZLE - POLYPROPYLENE AND KYNAR TIP - 3.7 GAL/HR PER NOZZLE
PLPF	PORTABLE FOAMER BACK PLATE W/ HINGE AND HOLES
PLPF-PIN	302 STAINLESS PORTABLE PLATE HINGE PIN
PLSS-AXL	AXLE PLATE - STAINLESS - 2.5 IN. X 1 IN. - 2 HOLES
PVCV34FM	PVC VALVE 3/4IN FPT X 3/4IN MPT
QF1438	MALE CON. ¾ IN. TUBE X ¼ IN. MPT - POLYPROPYLENE
QF5638	¾ IN. QF PUMP FITTING / G57
QFBH38	BULKHEAD ¾ IN. TUBE POLYPROPYLENE
QFEL1438	FIXED ELBOW ¾ IN. TUBE X ¼ IN. MPT - POLYPROPYLENE
QFSEL38	PLUG-IN ELBOW ¾ IN. TUBE X ¾ IN. POLYPROPYLENE
QFT38	UNION TEE ¾ IN. TUBE POLYPROPYLENE
R14	¼ NPTF REGULATOR W/ FILTER-NO GAUGE
R25DT	¾ X ¾ CLEAR PVC TUBING - AVAILABLE PER FT.
S812-FH	#8 X ½ IN. SCREW - STAINLESS - FLAT HEAD PHILLIPS
S5161812	5/16-18 X 1/2 PHIL PAN 18-8
SEL14M	STAINLESS ELBOW ¼ IN. MPT X ¼ IN. MPT
SN1414	STAINLESS HEX NIPPLE ¼ MPT X ¼ MPT
SSA14BKH	BULKHEAD ADAPTER - STAINLESS - ¼ NPT X ¼ NPSM
SSC38	STAINLESS SCREW BAND CLAMP FOR ¾ IN. HOSE
SSSFN12	SERRATED FLANGE NUT - STAINLESS - ½ IN.
SSU14	STAINLESS STEEL UNION- 1/4 INCH FP
STR38-IL	IN LINE STRAINER 3/8 BARB 20 MESH 304 STAINLESS EDPM GSKT
TNK-10N-IN	10 GAL NATURAL TANK INCLUDES SIDE INSERTS
W10	NONMARKING WHEEL FOR PORTABLE UNITS
WS-20CFM	WATER SEPARATOR - 20 CFM - ¼ IN. FPT PORTS