

Mist Unit

User Manual

MU50-PSGN130

MU100-PSGN130

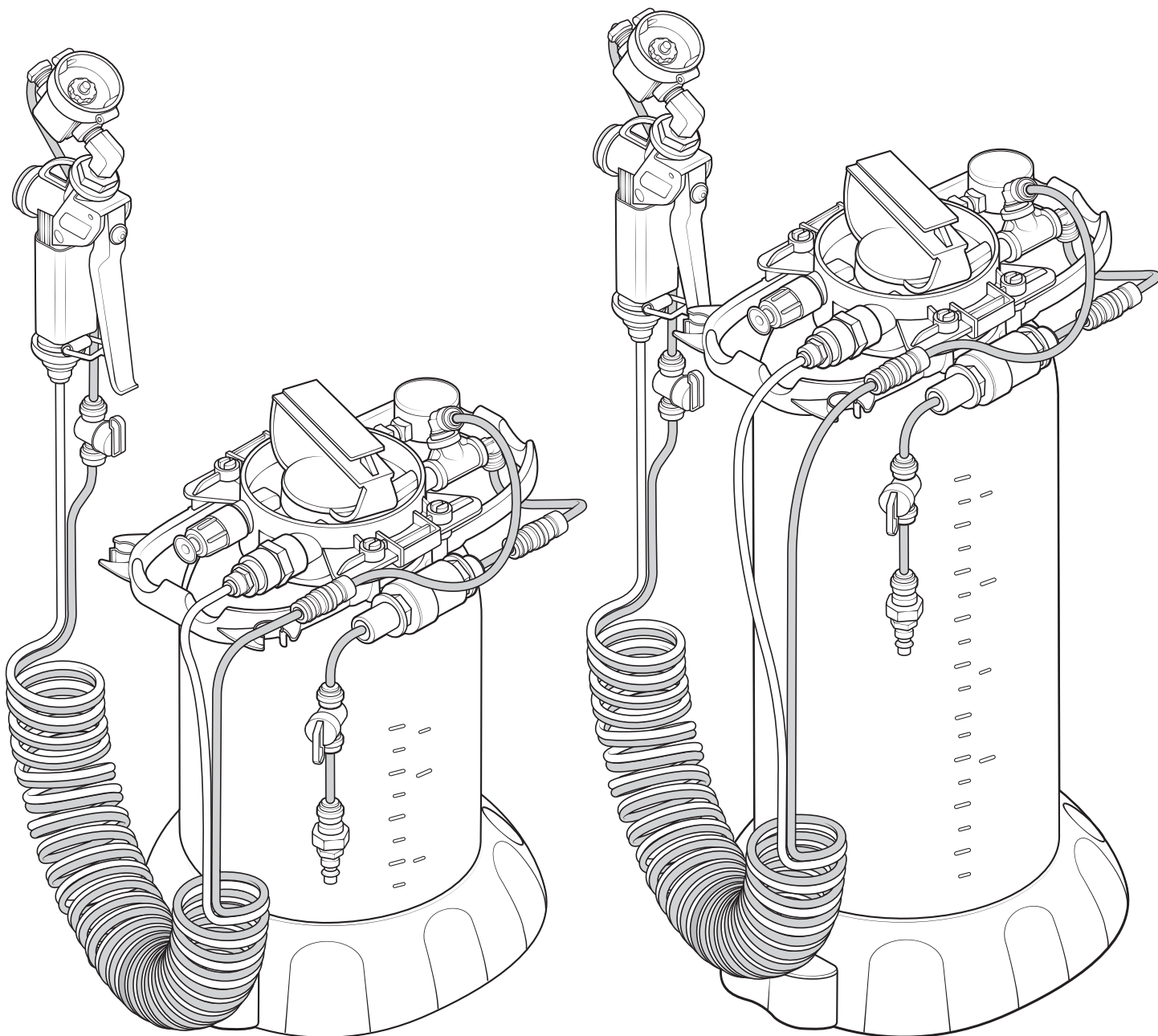

READ ALL INSTRUCTIONS BEFORE USING, OR SERVICING, THIS EQUIPMENT. KEEP THIS MANUAL IN A LOCATION THAT IS READILY AVAILABLE TO USERS AND SERVICE TECHNICIANS.

English (Original Instructions)

Contents

1 Safety..... 3

2 Product Overview..... 5

 Product Requirements..... 5

 Product Specifications..... 5

 Product Components 6

3 Operation 7

6 Parts 8

1 Safety

WARNING

PEOPLE OR OBJECTS CAN BE HURT OR DAMAGED IF THIS UNIT IS NOT USED CORRECTLY!



Failure to read all the instructions before operating the unit may result in personal injury or death from the improper use of the chemical solution. Anyone handling, operating or using the unit must read, and understand, the instructions in the manual. The buyer assumes all responsibility for safety and proper use in accordance with the instructions.



Using, or servicing, the unit without proper protective clothing, gloves, and eye wear may result in serious injury such as burns, rashes, eye, throat or lung damage and death. Always wear protective clothing, gloves, and eye wear when using, or servicing, the unit. Protect eyes, skin, and lungs against drifting spray.



Chemical solutions may pose a health risk and death if they contact the skin or eyes, are inhaled or swallowed. Always read, and follow, all chemical safety precautions and handling instructions provided by the chemical manufacturer and the Safety Data Sheet (SDS) associated with the chemical solution being used before using the unit.



Pressure within the equipment may cause an unexpected release of the chemical solution and cause serious injury such as burns, rashes, eye damage, throat or lung damage and death. Always depressurize and clean the unit after each use. Never leave the unit unattended while pressurized.

Using the unit with fluid temperatures above 100°F (37.77°C) may result in scalding, burns, serious injury or death. DO NOT use a solution with a temperature above 100°F (37.77°C).

Operating the unit when damaged or leaking may result in exposure to chemical solutions, serious injury or death. Never use the unit if it is damaged or leaking.

Never point the discharge wand at yourself, another person, or any object you do not want covered in chemical.



Using incoming air pressure exceeding 100 psi (7 bar) may result in pressure buildup, explosion, serious injury or death. DO NOT exceed 100 psi (7 bar) incoming air pressure when operating the unit.

Use of hydrocarbons and flammable products may result in explosions, fire and serious injury or death. Never use hydrocarbons or flammable products with the unit.



Mixing an alkaline with an acid may result in a chemical reaction. Overheating of the mixture may cause it to splatter caustic compounds or release hazardous fumes, gas and vapors. Always flush the unit with fresh water for five (5) minutes when switching from an alkaline to an acid or an acid to an alkaline.

NOTICE

Servicing, or modification, of this unit with parts not listed in this manual may cause the unit to operate improperly. Do not use unauthorized parts when servicing the unit.

Use of an air lubricator before the unit may result in diminished performance and damage to the unit. Do not use an air lubricator before the unit.

Moisture in the air lines may damage the pump and diminish the units life. The air must be filtered, clean, dry and free of moisture. If needed, install an air dryer before the unit.

PROTECT THE ENVIRONMENT



Please dispose of packaging materials, old machine components, and hazardous fluids in an environmentally safe way according to local waste disposal regulations.

2 Product Overview

Product requirements

Compressed air requirements	40 psi (3 bar) with 2-5 cfm (57-142 l/min)
Liquid temperature range	40-100°F (4.4-37°C)
Chemical compatibility	Chemical products used with this equipment must be formulated for this type of application and compatible with unit materials and pump seals. For more information on chemical compatibility, consult the manufacturer or SDS for your product or contact our customer service department.

Product specifications

	MU50-PSGN130	MU100-PSGN130
Power type	Compressed air	
Chemical pickup type	Draws from pre-mixed solution	
Number of products unit can draw from	One product	
Capacity	1.3 gallons (5 liters)	2.6 gallons (10 liters)
Discharge line length/diameter	12 ft. (3.6 m) coiled twin-line tubing ¼ in. (6.4 mm outside diameter), red and blue, with 0.16 in. (4.06 mm) inside diameter	
Discharge wand/tip type	Polypropylene trigger handle for liquid output and polypropylene fog/mist nozzle with Kynar tip	
Output distance	3-4.5 ft. (0.9-1.4 m)	
Output volume	8.79 oz./min. at 40 psi	
Flow rate*	8.79 oz./min. at 40 psi	
Pump seals	Viton	
Run time from full tank**	Approximately 19 minutes	Approximately 38 minutes
Nozzle type	Pneumatic fog nozzle	
Number of nozzles	One	

* Dilution rates and flow rates given are based on chemical with viscosity of water and factory air pressure settings.

** Area covered and run time may vary based on humidity, air flow, and product used.

Product components

Before you begin get to know the MU50-PSGN130 or MU100-PSGN130 components that you will need to use, adjust or assemble.

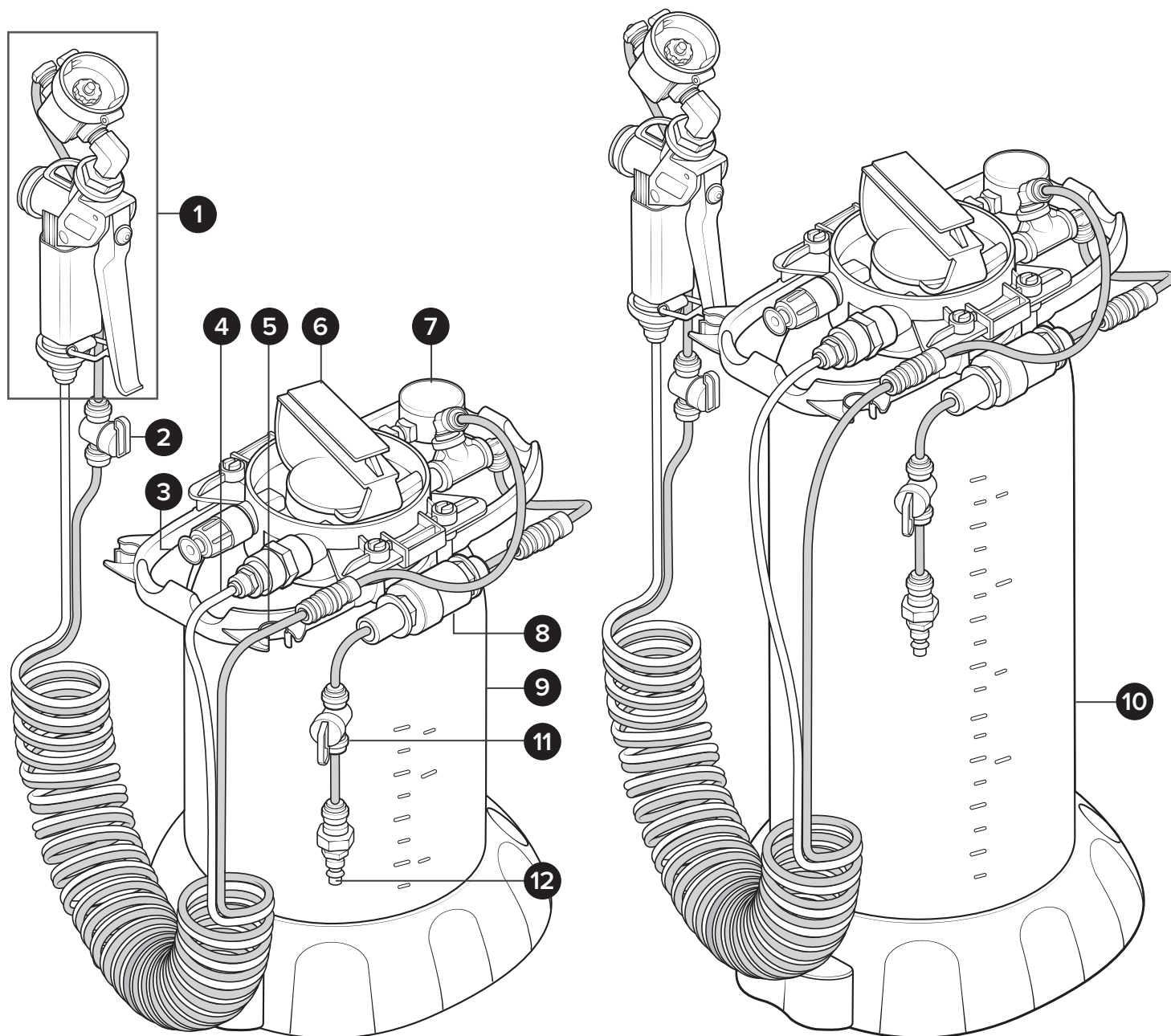

- | | |
|---------------------------------|------------------------------|
| 1. PSG-N130 wand | 8. Pressure reducing valve |
| 2. Air discharge shut-off valve | 9. 5 liter tank |
| 3. Pressure relief valve | 10. 10 liter tank |
| 4. Discharge hose | 11. Air inlet shut-off valve |
| 5. Air supply hose | 12. Air fitting |
| 6. Pump handle | |
| 7. Air gauge | |

3 Operation

1. Ensure all air pressure is released from unit by pulling the pressure relief valve stem out.
2. Securely hold the unit and unscrew the pump assembly from the tank in a counterclockwise direction.
3. Follow all instructions from chemical manufacturer. Fill tank 3/4 of the way with pre-mixed solution.

Note: Do not overfill tank with solution.

4. Securely hold the tank and screw the pump assembly back on in a clockwise direction.
5. With the air discharge shut-off valve and air inlet shut-off valve in the closed position, plug an air supply line into the air fitting. The pressure is regulated to 40 psi with the pressure reducing valve.

Note: The pressure relief valve will leak if the air pressure is too high. Do not overfill tank with air.

6. Point the discharge wand in a safe direction and open the air discharge shut-off valve and air inlet shut-off valve. Then squeeze the trigger handle to begin misting.

Note: Both air valves should be completely open while misting.

7. To stop misting, release the trigger handle and then close the air discharge shut-off valve.

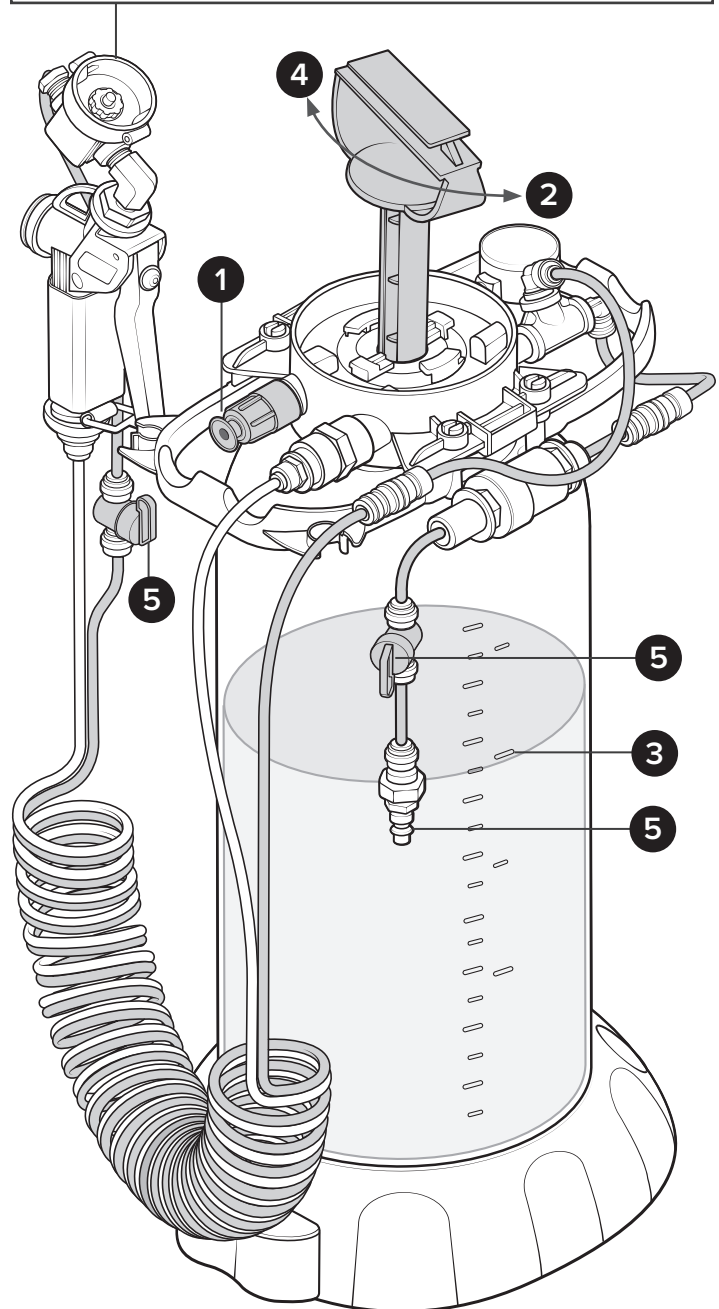
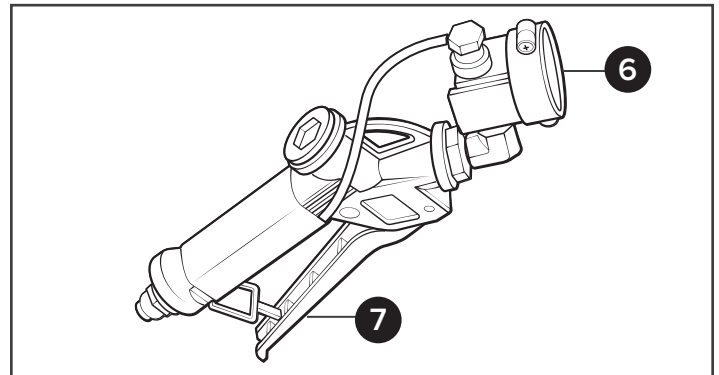

After Use Instructions

1. Disconnect the airline from the air fitting. Release air pressure from unit after each use by activating the pressure relief valve.
2. Flush the unit with fresh water. It is recommended to always empty out remaining solution and run fresh water through the unit to rinse all parts thoroughly after each use and before storage.

4 Parts

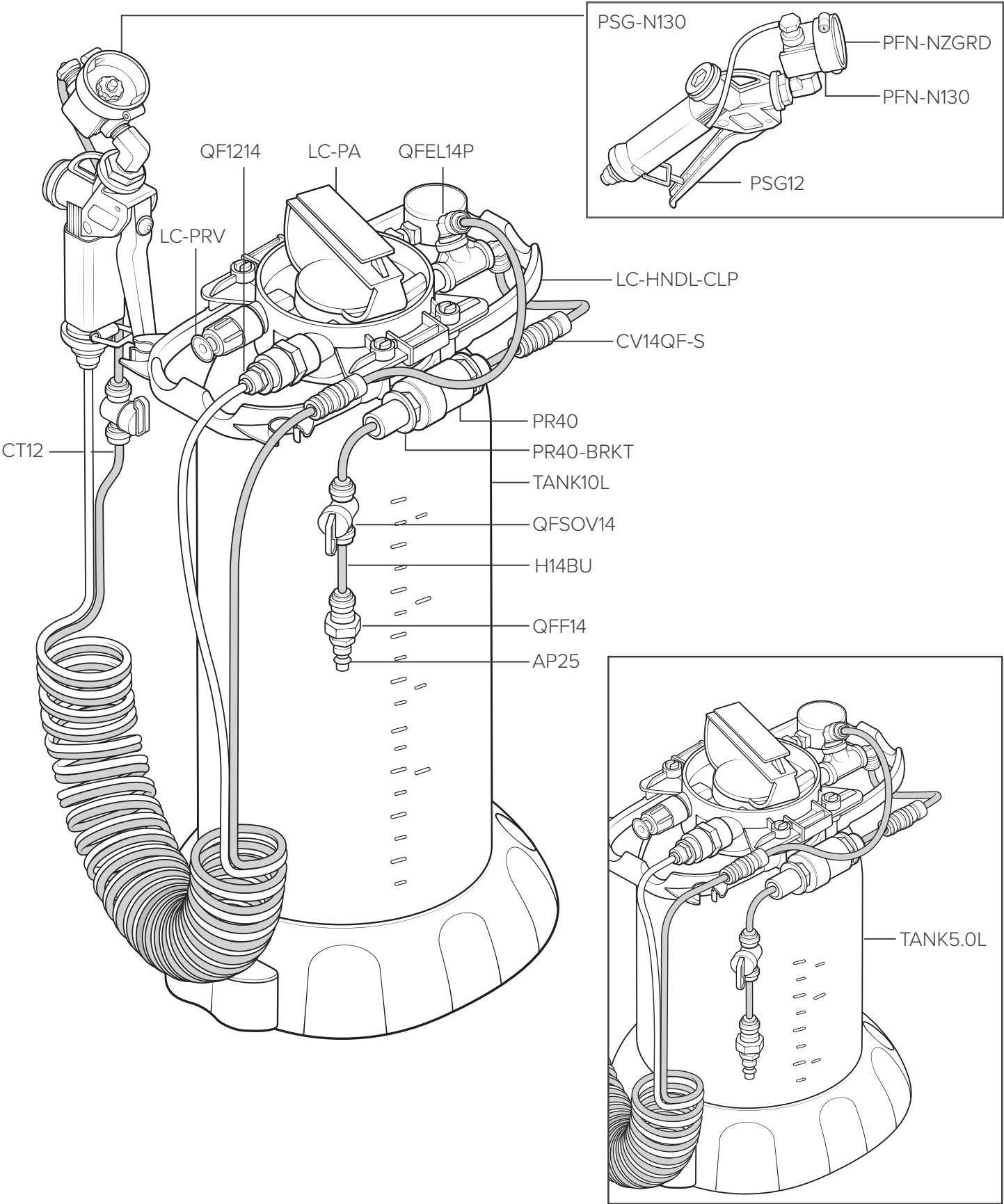

Item number	Description
AP25	Air fitting 1/4 MPT x plug-nickel-plated brass
CT12	12 ft. coiled 1/4 in. polyurethane red/blue tubing
CV14QF-S	1/4 Tube x 1/4 tube check quick fit-small
H14B-F	1/4 in OD blue polyurethane tubing - Available per ft.
LC-HNDL-CLP	Tank handle for 5L/10L-with clips
LC-PA	Manual pump assembly for 5L/10L-viton
LC-THA-MU50	Tank head assembly for MU50-includes PRV and LC-PST-5.0L
LC-THA-MU100	Tank head assembly for MU100-includes PRV and LC-PST-10L
PFN-N130	Pneumatic fog nozzle - polypropylene and kynar tip - 3.7 gallon/hour per nozzle
PFN-NZGRD-A	Nozzle guard assembly for pneumatic fog nozzles-includes 2 guards and hardware
PR40	PVC Valve 3/4 in. FPT X 3/4 in. MPT
PR40-BRKT	Bracket for PR40
PSG12	1/2 in poly spray gun with o-ring and gray handle & 316SS
PSG-N130	PSG12 gun with PFN-N130 and nozzle guard
QF1214	Quick fit-1/2 MPT x 1/4 OD tube-polypropylene
QFEL14P	Fixed elbow 1/4 in. tube x 1/4 in. MPT - polypropylene
QFF14	Female adapter 1/4 in. tube x 1/4 in NPTF polypropylene
QFSOV14	Shut off valve 1/4 in. tube - polypropylene
TANK5.0L	5 liter tank
TANK10L	10 liter tank