USER MANUAL

MODEL NUMBER:

NZA-DS-TL-1

NZA-DS-TL-2

NZA-DS-TL-3

Twin-Line Doorway Foam Nozzle Assembly

English (Original Instructions)

READ ALL INSTRUCTIONS BEFORE OPERATING EQUIPMENT



WARNING



Read this manual completely and understand the machine before operating or servicing it.

- Read all instructions before installing or operating unit.
- Always wear appropriate personal protective equipment (PPE) when operating or servicing unit.
- Always follow all chemical safety precautions and handling instructions provided by the chemical manufacturer and Safety Data Sheet (SDS).
- If this unit is modified or serviced with parts not listed in this manual, the unit may not operate correctly.
- Do not exceed an incoming air pressure of 100 psi (6.9 bar).
- Do not exceed a fluid temperature of 100°F (37.8°C).
- Always flush the unit with fresh water for 5 minutes when switching from an alkaline to an acid or an acid to an alkaline.
- Never use unit with hydrocarbons or flammable products.
- Only use clean and dry air. Air must be filtered and free of moisture or pump life will be diminished. If needed, install an air dryer before unit.
- Do not use an air lubricator before the unit.
- Never use unit if it is damaged or leaking.
- Disconnect unit from electrical power source before servicing.

PROTECT THE ENVIRONMENT

Please dispose of packaging materials, old machine components, and hazardous fluids in an environmentally safe way according to local waste disposal regulations.



Always remember to recycle.

*Specifications and parts are subject to change without notice.

READ ALL INSTRUCTIONS BEFORE OPERATING EQUIPMENT

Installation Instructions:

1. Remove all components from packaging.

2. Mount the stainless steel nozzle assembly in the desired location, using two stainless steel brackets and four of the screws and plastic anchors provided in the parts package. Repeat as needed for multiple nozzles.
Note: The foam pattern dimensions provided in this manual were measured with nozzle assemblies mounted 6 in. (15 cm) above the floor.

3. Run tubing from the solution outlet fitting on the control box to the solution inlet fitting on the nozzle assembly. For multiple nozzles, run the tubing from the control box into a tee fitting, as shown in the diagram. Then, run tubing from the tee fitting to the nozzle assemblies. For systems with three nozzles, use a second tee fitting to split the line again.

4. Run tubing from the air outlet fitting on the control box to the air inlet fitting on the nozzle assembly. For multiple nozzles, split the line using one or more tee fittings, as described in step 6 and shown in the diagram.

Note: The air and solution lines must be routed to the appropriate fittings (as labeled), or the foam quality of the unit will be negatively impacted. Make sure to insert the tubing all the way into the fittings to ensure proper connection.

5. When running multiple tip assemblies off one control box, it is recommended to change spray nozzle based on chart specification below:

| Item Number | Number of Tip Assembly | Recommended Spray Nozzle |
|--|------------------------|--------------------------|
| NZA-DS-TL-1 | 1 | ST80200SS |
| NZA-DS-TL-2 | 2 | ST80100SS |
| NZA-DS-TL-3 | 3 | ST8060-12SS |
| Air operation range: 40 to 80 PSI (2.8 to 5.5 bar) with 3.5 to 8 CFM (99.1 to 226.6 l/min) | | |

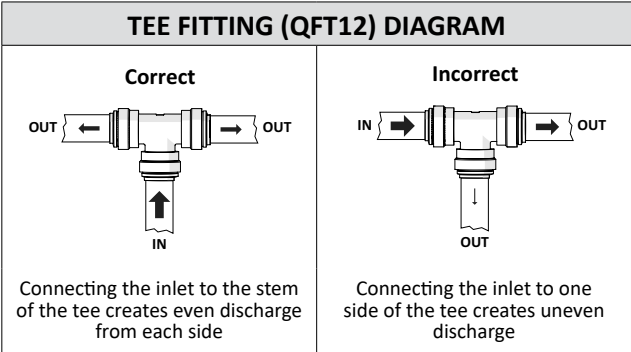

READ ALL INSTRUCTIONS BEFORE OPERATING EQUIPMENT

NOZZLE ASSEMBLY

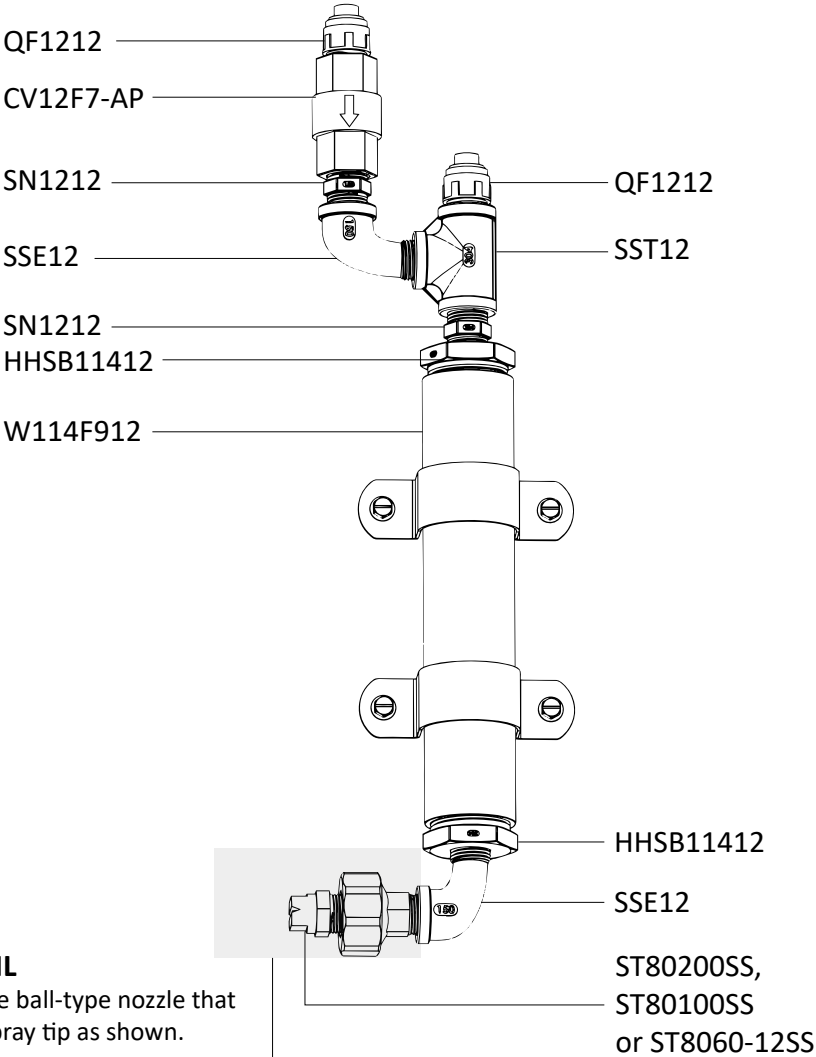

NOZZLE ASSEMBLY DETAIL

This unit includes an adjustable ball-type nozzle that may be installed to hold the spray tip as shown.

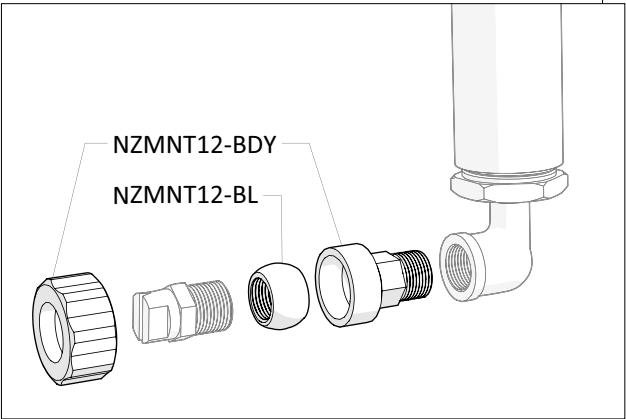

Note: Spray tip size varies based on number of nozzle assemblies used - see specifications chart for more information

READ ALL INSTRUCTIONS BEFORE OPERATING EQUIPMENT

| ITEM NUMBER | ITEM DESCRIPTION |
|---------------|--|
| BRKT-W114 | BRACKET - STAINLESS STEEL - FOR MOUNTING 1 1/4IN DISCHARGE WAND |
| CV12F7-AP | 1/2 CHECK VALVE 7 LB SPRING - HASTELLOY SPRING - EP SEALS - ACID PROOF - BLK/WHT CHK |
| HHSB11412 | HEX HEAD STAINLESS BUSHING 1-1/4 MPT X 1/2 FPT |
| NZMNT12-BDY | NOZZLE MOUNT BODY - 1/2IN MPT - BLACK AND GRAY POLYPROPYLENE - ACCEPTS NOZZLE MOUNT BALL |
| NZMNT12-BL | NOZZLE MOUNT BALL - 1/2IN FPT - BLACK POLYPROPYLENE - FOR NOZZLE MOUNT BODY |
| PRCH-MXSS-MSH | MIXING MEDIA - STAINLESS - BALL - AS PURCHASED |
| QF1212 | QUICK FIT-1/2 MPT X 1/2 OD TUBE-POLYPROPYLENE |
| SN1212 | STAINLESS HEX NIPPLE 1/2 MPT X 1/2 MPT |
| SSE12 | STAINLESS STREET ELBOW - 304 STAINLESS STEEL - 1/2IN FPT X 1/2IN MPT |
| SST12 | STAINLESS TEE 1/2 FPT |
| ST80200SS | SPRAY TIP-80 DEGREE-20.0 GPM-STAINLESS-1/2 MPT |
| ST80100SS | SPRAY TIP-80 DEGREE-10.0 GPM-STAINLESS-1/2 MPT |
| ST8060-12SS | SPRAY TIP-80 DEGREE-6.0 GPM-STAINLESS-1/2 MPT |
| STRD114 | STRAINER - 316 STAINLESS DISC - 1 1/4IN DIAMETER - #20 MESH |
| TB12N-PE | 1/2IN OD NATURAL TUBE - POLYETHYLENE - AVAILABLE PER FT |
| W114F912 | 1 1/4IN FNPT AND 1 1/4IN FNPT FOAM TUBE - POLISHED STAINLESS - 9 1/2IN LONG |
| WMS14 | WALL MOUNT SCREW - #14 X 1 1/4IN - STAINLESS STEEL - HEX HEAD SLOTTED |
| WMS14A | WALL MOUNT SCREW ANCHOR -#14 X 1 1/4IN - PLASTIC - 5/16IN DRILL SIZE |