USER MANUAL

MODEL NUMBER:

SS2

SS2-FMH

SS2-MBS

AND RELATED UNITS

Footwear Sanitation System

English (Original Instructions)

READ ALL INSTRUCTIONS BEFORE OPERATING EQUIPMENT



WARNING



Read this manual completely and understand the machine before operating or servicing it.

- Read all instructions before operating or interacting with this unit.
- Always wear appropriate personal protective equipment (PPE) when operating or servicing unit.
- Always follow all chemical safety precautions and handling instructions provided by the chemical manufacturer and Safety Data Sheet (SDS).
- If this unit is modified or serviced with parts not listed in this manual, the unit may not operate correctly.
- This unit is for use with fully protective footwear only.
- Chemical Spray Hazard
 - o Insert foot fully into unit and press down with heel. Partial insertion may cause chemical spray to face and eyes.
 - o Wear splash goggles when required by chemical manufacturer, SDS, or OSHA.
 - o Do not remove or modify spray guard.
- Always disconnect the unit from compressed air before performing any maintenance.
- Do not exceed an incoming air pressure of 130 psi (9 bar).
- Do not exceed a fluid temperature of 100°F (37.8°C).
- Never use unit with hydrocarbons.

PROTECT THE ENVIRONMENT

Please dispose of packaging materials, old machine components, and hazardous fluids in an environmentally safe way according to local waste disposal regulations.



Always remember to recycle.

*Specifications and parts are subject to change without notice.

INTENDED USE

This machine is designed to help sanitize footwear at transition zones with a focus on reduced moisture. This machine is intended to sanitize shoe soles and not intended for any other use.

OPTIONS

System Add-On		
SS2	-	None (<i>standard</i>)
		Floor mounted handle (FMH)
		Manual boot scrubber (MBS)

Add bold option codes to item number as shown. For standard options, no option code is needed.

Examples:

- SS2 (standard unit)
- SS2-FMH (unit with floor mounted handle)
- SS2-MBS (unit with manual boot scrubber)

READ ALL INSTRUCTIONS BEFORE OPERATING EQUIPMENT

REQUIREMENTS	
Compressed air requirements	40-60 psi (2.8-4.1 bar) with 1 cfm (28.3 l/min)
Recommended operating air pressure	40 psi (2.8 bar) with 1 cfm (28.3 l/min)
Liquid temperature range	40-100°F (4.4-37.8°C)
Chemical compatibility	Chemical products used with this equipment must be formulated for this type of application and compatible with unit materials and pump seals. For more information on chemical compatibility, consult the manufacturer or SDS for your product or contact our customer service department.

SPECIFICATIONS	
Power type	Compressed air
Chemical pickup type	Draws from pre-mixed product
Number of products unit can draw from	One product
Suction line length/diameter	3 ft. (0.9 m) clear hose with 1/4 in. (6.4 mm) inside diameter
Output volume*	0.2 oz. (5.9 mL) per spray
Pump seals	Viton
Number of nozzles	4 nozzles
Dimensions (LxWxH)	SS2: 24.7x11x18 in. (62.7x27.9x45.7 cm) approximately SS2-FMH: 27.1x15.7x41.5 in. (68.9x39.9x105.4 cm) approximately SS2-MBS: 28.7x29.2x40.3 in. (72.9x74.2x102.4 cm) approximately
Weight	SS2: 24 lbs (10.9 kg) approximately FMHA-SS2: 16 lbs (7.3 kg) approximately, SS2-FMH: 40 lbs (18.1 kg) approximately MBS-C: 34 lbs (15.4 kg) approximately, SS2-MBS: 58 lbs (26.3 kg) approximately
Noise level	Less than 70 dB(A)

*Dilution rates and flow rates given are based on chemical with viscosity of water and factory air pressure settings.

READ ALL INSTRUCTIONS BEFORE OPERATING EQUIPMENT

LIFT POINTS:

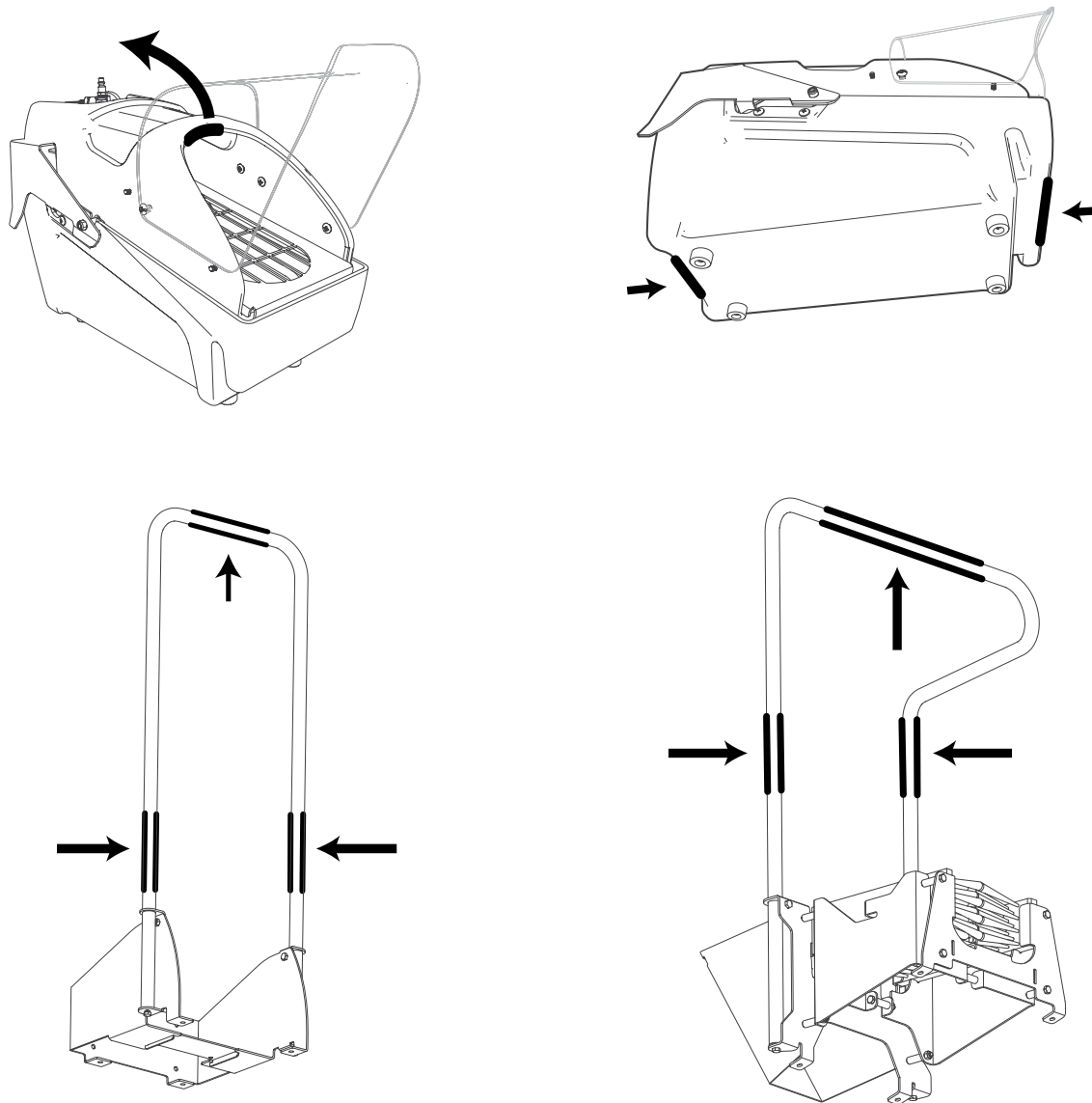

INSTRUCTIONS:

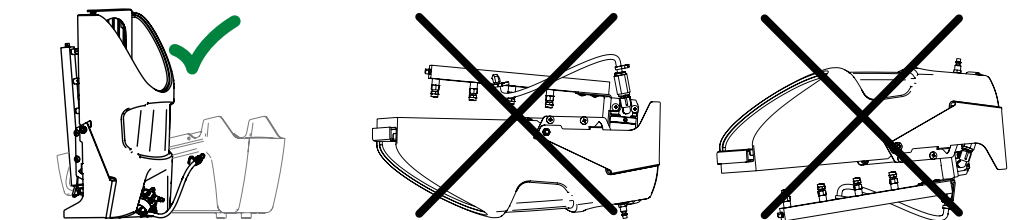

READ ALL INSTRUCTIONS BEFORE OPERATING EQUIPMENT

Installation Instructions:

For SS2 Unit:

1. Select suitable location to place the unit.
2. If desired, mount the chemical jug to the wall using the provided mounting hardware and rack.
Note: To drill holes for plastic anchors, use a $\frac{5}{16}$ inch drill bit. The chemical jug should not be mounted higher than 30 in. (0.7 m) above the unit. Suction hose length should not exceed 8 ft. (2.4 m).
3. Connect an air line to the air fitting.
4. Follow all instructions from chemical manufacturer. Fill the chemical jug with pre-mixed or ready-to-use chemical solution and connect the suction line to the jug suction fitting.
5. Prime the unit according to the Priming Instructions.

For SS2-FMH Unit:

1. Select desired location to mount footwear sanitizing unit.
2. Attach handle to handle bracket with bolts on the ends. Secure by tightening bolt and lock nut on both sides.
3. Mount handle assembly to floor or wall (hardware not included).
4. Lift up on the shroud, rotate top half of the unit, and slide top half of unit from the bracket to release from base.

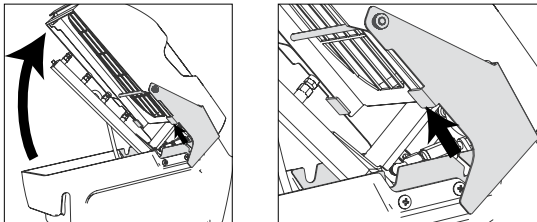

5. Hook the plate on the underside of the collection basin to the bracket at the base of the mounting handle.

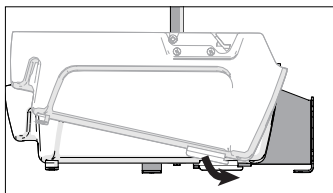

6. If desired, mount the chemical jug to the wall using the provided mounting hardware and rack.

Note: To drill holes for plastic anchors, use a $\frac{5}{16}$ inch drill bit. The chemical jug should not be mounted higher than 30 in. (0.7 m) above the unit. Suction hose length should not exceed 8 ft. (2.4 m).

7. Connect an air line to the air fitting.
8. Follow all instructions from chemical manufacturer. Fill the chemical jug with pre-mixed or ready-to-use chemical solution and connect the suction line to the jug suction fitting.
9. Prime the unit according to the Priming Instructions.

For SS2-MBS Unit:

10. Select suitable location to place the unit.
11. Attach handle to boot scrubber base with bolts on ends. Secure by tightening bolt and lock nut on both sides.
12. Slide debris tray under boot scrubber, lift up and hook tray into slots on front of the boot scrubber frame to secure.
13. Connect debris shield by sliding hooks into the slots on the back the boot scrubber frame.
Note: Brushes must be removed before installing/uninstalling debris shield.
14. Position boot scrubber in desired location and mount to floor (hardware not included).
15. Position mounting bracket for footwear sanitizer next to the boot scrubber and secure to the floor (hardware not included).
16. Hook the plate on the underside of the collection basin to the mounting bracket.

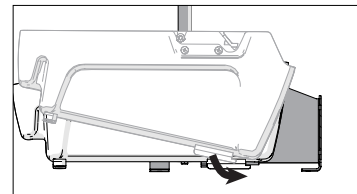

17. If desired, mount the chemical jug to the wall using the provided mounting hardware and rack.

Note: To drill holes for plastic anchors, use a $\frac{5}{16}$ inch drill bit. The chemical jug should not be mounted higher than 30 in. (0.7 m) above the unit. Suction hose length should not exceed 8 ft. (2.4 m).

18. Connect an air line to the air fitting.
19. Follow all instructions from chemical manufacturer. Fill the chemical jug with pre-mixed or ready-to-use chemical solution and connect the suction line to the jug suction fitting.
20. Prime the unit according to the Priming Instructions.

READ ALL INSTRUCTIONS BEFORE OPERATING EQUIPMENT

⚠ WARNING: Chemical Spray Hazard

- Insert foot fully into unit and press down with heel. Partial insertion may cause chemical spray to face and eyes.
- Wear splash goggles when required by chemical manufacturer, SDS, or OSHA.
- Do not remove or modify spray guard.

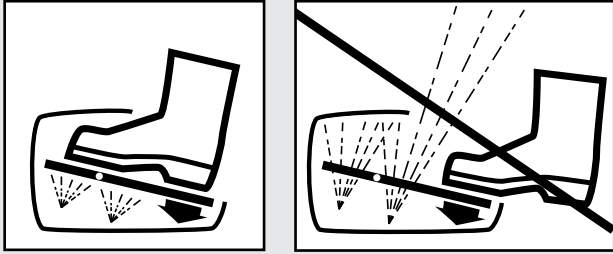

Priming Instructions:

Note: This unit is for use with fully protective footwear only. Do not activate the unit if a user's foot is not positioned inside the spray guard.

1. Verify that the chemical jug is full, and connect the jug to the unit suction line. Check all tubing connections and verify that none are loose or leaking.
2. Place foot on the grate and step down with heel until all air has been purged from the suction line.
3. Check bottom of footwear for proper sanitizer application. The entire sole should be covered with a consistent spray pattern.

Operation Instructions:

For SS2 Unit:

1. Place one foot on the grate and step down with heel to activate the spray.
2. Repeat the process with your other foot.

For SS2-FMH Unit:

1. Grip the handle with both hands to establish 3 points of contact.
2. Place one foot on the grate and step down with heel to activate the spray.
3. Repeat the process with your other foot.

For SS2-MBS Unit:

1. Grip the handle above the manual boot scrubber with both hands to establish 3 points of contact.
2. Place one foot in the brushes and push foot back and forth to remove debris. Repeat the process with your other foot.
3. Move to the footwear sanitizer and grip the handle above with both hands to establish 3 points of contact.
4. Place one foot on the grate and step down with heel to activate the spray.
5. Repeat the process with your other foot.

READ ALL INSTRUCTIONS BEFORE OPERATING EQUIPMENT

Maintenance Instructions:

The unit should be cleaned regularly to ensure that it is in a clean condition. Cleaning schedule will depend on frequency of use and types of soils. Follow daily maintenance instructions to keep the unit clean; clean more often if necessary. Clean parts by any method suitable for the material type and safe for the facility environment. For example: use food-safe cleaner and food-safe material in a food processing facility.

Always wear appropriate personal protective equipment (PPE) when operating or servicing unit. Before performing any maintenance, disconnect the unit from the compressed air supply. After maintenance is complete, reconnect compressed air, verify suction line and fittings are secure, and re-prime the unit according to the Priming Instructions.

Daily Maintenance for SS2, SS2-FMH, and SS2-MBS Units:

- Inspect the stainless foot grate and shroud for soil and wipe clean.
- Wipe clean the polycarbonate spray guard.
- The basin should be emptied and cleaned each time the chemical supply container is changed or refilled. Follow instructions on how to clean collection basin.
- Verify that the nozzle assembly is free of any debris or blockage. Rinse with low pressure water if necessary.
- Inspect all tubing for leaks or excessive wear. Make sure all hose clamps and push fittings are in good condition and properly secured.

Daily Maintenance for SS2-MBS Unit Only:

- Remove brushes by lifting them out from the brush bracket. Remove debris and clean. Brushes should be replaced every 6 months depending on wear.
- Slide out debris tray. Empty debris and wipe clean.
- Lift up on debris shield to remove.
- Base assembly of the unit is fully stainless and can be cleaned in place by any method suitable for stainless steel.

How To Clean Collection Basin:

- Empty collection basin
 - a. Lift up on the shroud, rotate the top half of the unit, and slide top half of unit from the bracket to release from the base.

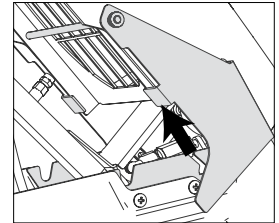
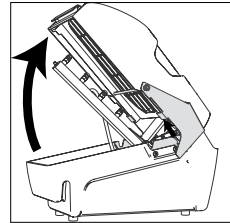

- b. Stand top half of unit on short end. Setting unit down in other position may cause damage to nozzle assembly.

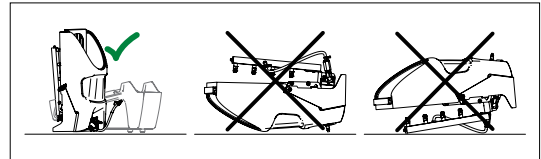

- c. Grab handle on front of collection basin and tip up to empty.
- d. Slide top half of unit back into place on collection basin.

READ ALL INSTRUCTIONS BEFORE OPERATING EQUIPMENT

Maintenance Instructions continued:

Other Maintenance for SS2, SS2-FMH, and SS2-MBS Units:

- Inspect all parts of the unit regularly, and clean if necessary.

PARTS MATERIAL LIST:

DESCRIPTION	ITEM NUMBER	MATERIAL TYPE
Manifold	MN-SS2	PVC
Nozzles	FCN12016	PVDF
Checks	CVSS18MF	stainless steel
Mounting frame	FRM-SS2	stainless steel
Pump	PMPA-FLD-SS2	polypropylene
Check valves	CV14HB14M, CV14M14HB	PVC
Shroud	SHR-SS2	polyethylene
Spray guard	SPGRD-SS2	polycarbonate
Clear tubing	H14CL-PV, H38CL-PV	PVC
Red/Blue tubing	TB14BL-PU	polyurethane
Roller cam	ACVB-3W2P-RCA	stainless, nylon
Two-way air valve	VLVA-3W2P-AFS	brass body with stainless steam
Other metal fittings	N/A	stainless steel
Other plastic fittings	N/A	polypropylene

Troubleshooting Instructions:

If footwear sanitizing unit will not spray:

- Check valve stem and roller cam to ensure proper movement and compression (Refer to Figure 1 below)
- If the pump is cycling, but the unit does not spray, the pump may be air locked.
- Check the suction line and strainer for debris and clean if necessary.

FIGURE 1

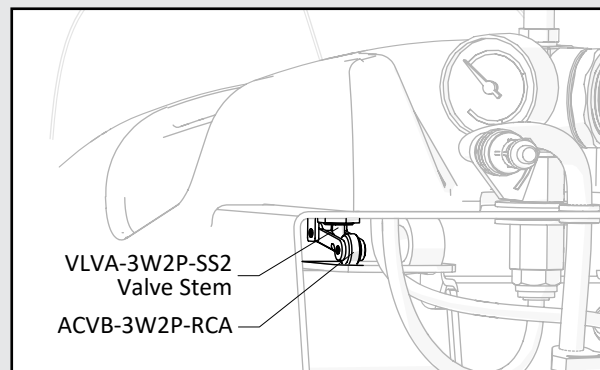

If footwear sanitizing unit sprays irregularly:

- Verify that the unit is connected to an appropriate compressed air source. This unit requires 40 psi (2.8 bar) with 1 CFM (28.3 l/min) to operate. To maximize unit lifespan and performance, compressed air should be clean and dry.
Note: If air source has a high moisture content, install a water separator before the unit.
- Verify the pump is cycling regularly. The pump can be disassembled and the o-ring can be relubricated with a silicone-based lube.
- Check the spray tips and make sure they are not clogged or blocked by debris. The spray tips may be removed and cleaned if necessary.

If the unit does not hold a prime:

- Check hose clamps and ensure that barbs are secure.
- Check all tubing connections and verify that none are loose, broken, or leaking.

READ ALL INSTRUCTIONS BEFORE OPERATING EQUIPMENT

PARTS DIAGRAMS - UNITS WITH STANDARD FITTINGS

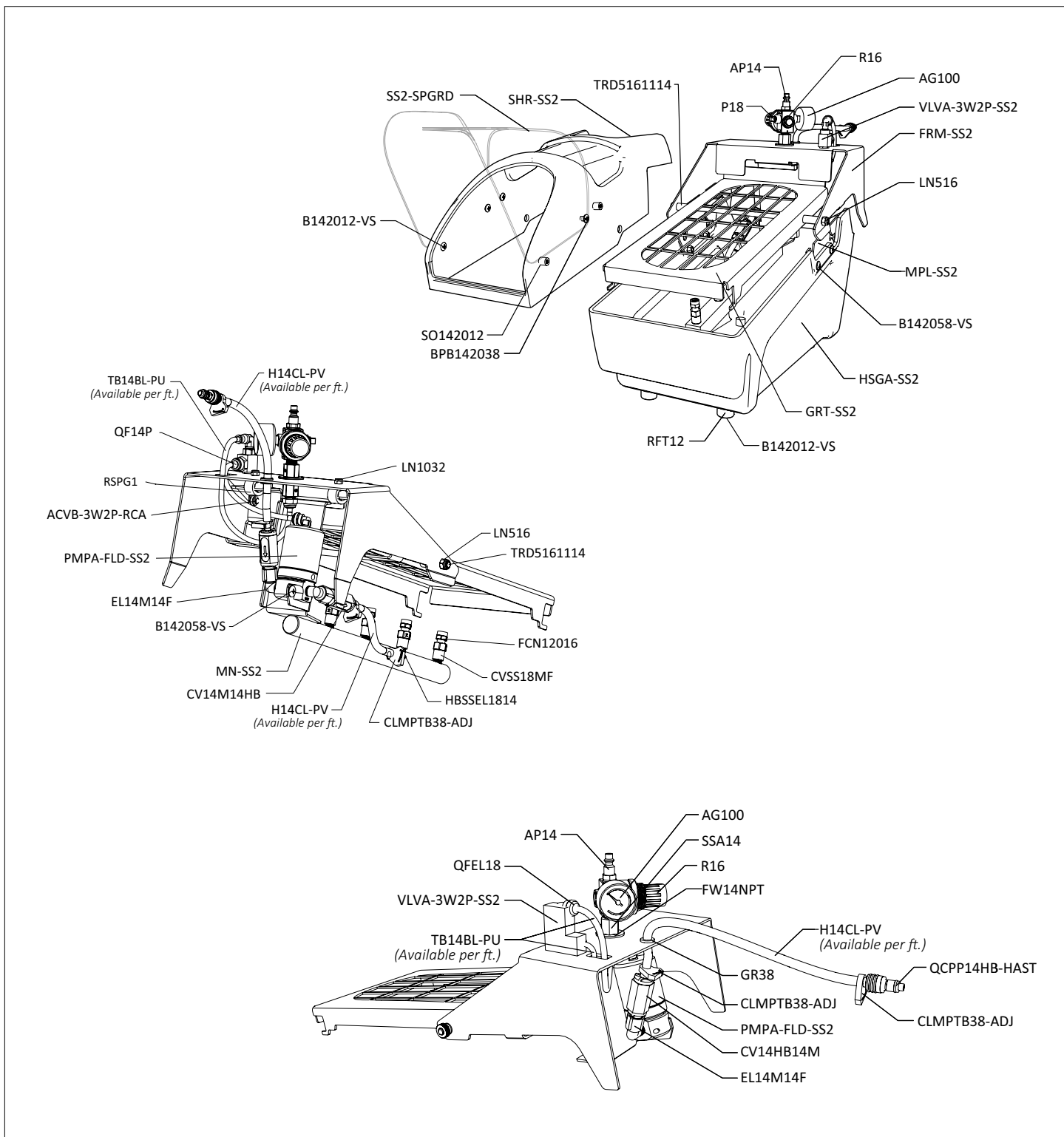

READ ALL INSTRUCTIONS BEFORE OPERATING EQUIPMENT

PARTS DIAGRAMS

MANUAL BOOT SCRUBBER ASSEMBLY ITEM NUMBER: MBS-C

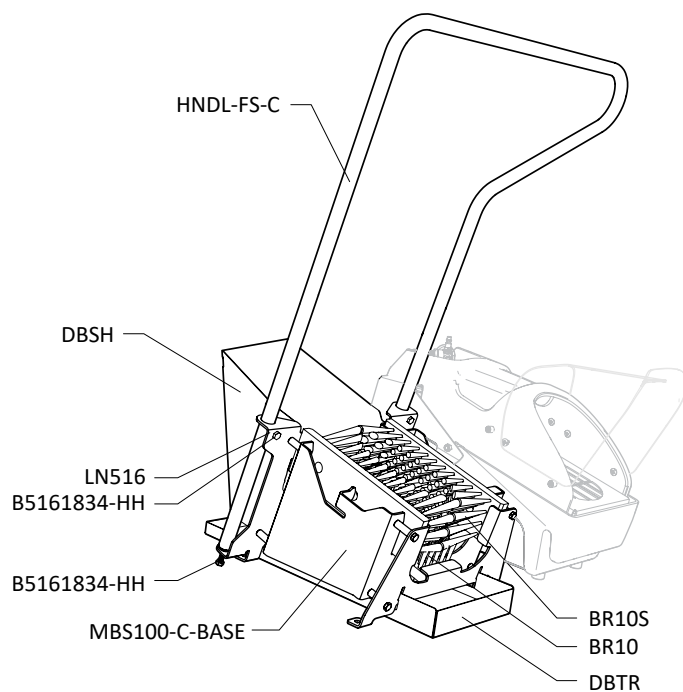

MBS100-C MOUNTING PLATE FOR SS2 ITEM NUMBER: FMPL-SS2

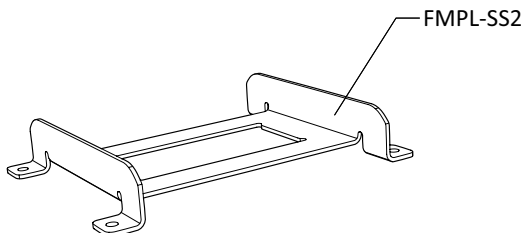

FLOOR MOUNTED HANDLE ASSEMBLY ITEM NUMBER: FMHA-SS2

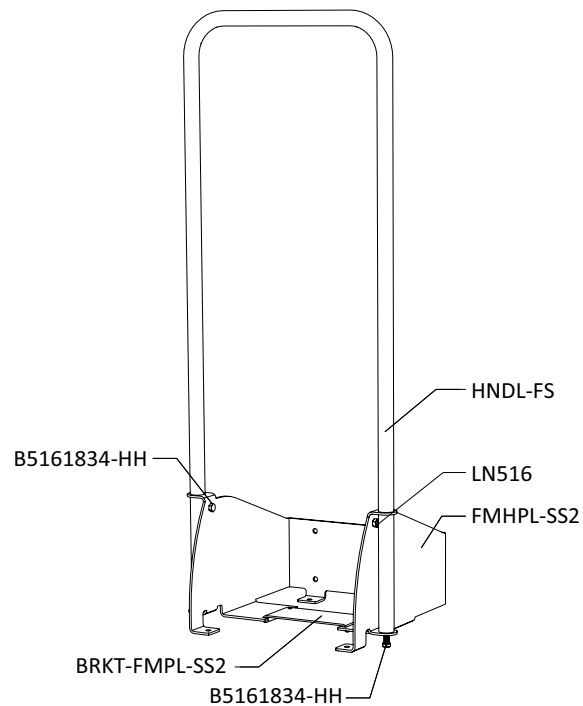

READ ALL INSTRUCTIONS BEFORE OPERATING EQUIPMENT

PARTS DIAGRAMS

STAINLESS STEEL JUG RACK
ITEM NUMBER: SSJR2

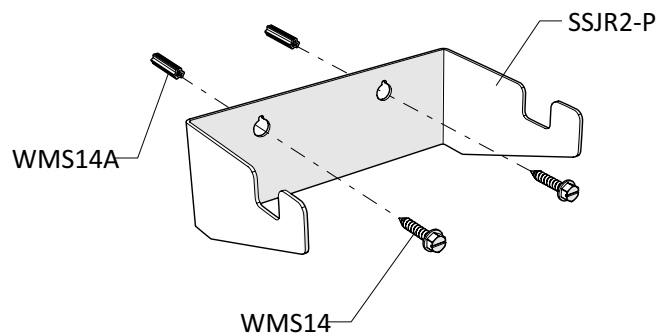

NON-LOCKING ONE-WAY VENTED CAP FOR JUGS WITH SUCTION FITTINGS
ITEM NUMBER: JC35B-TAV

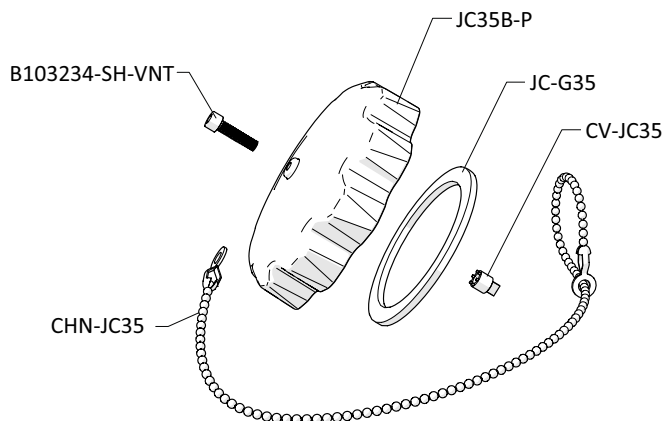

JUG BODY

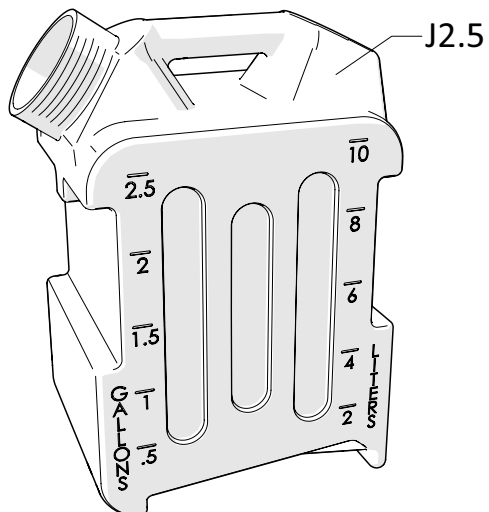

SUCTION FITTINGS REPLACEMENT KIT
ITEM NUMBER FOR 2.5 GALLON JUG: J2.5-SR

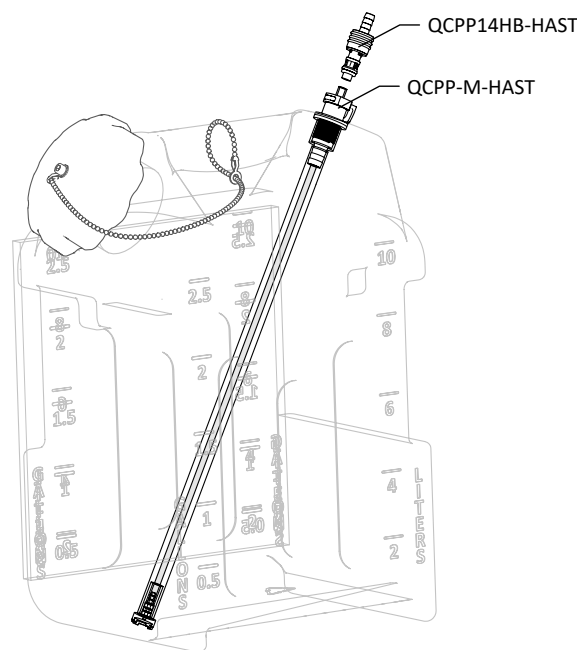

READ ALL INSTRUCTIONS BEFORE OPERATING EQUIPMENT

ITEM NUMBER	DESCRIPTION
ACVB-3W2P-RCA	AIR CONTROL VALVE - NICKEL-PLATED BRASS - 3 WAY 2 POSITION - ROLLER CAM ACTUATOR
AG100	AIR GAUGE-1/8IN NPT-100 PSI DRY MODEL
AP14	AIR FITTING 1/4 MPT X PLUG-NICKEL-PLATED BRASS
B103212-PH	10-32 X 1/2IN BOLT - STAINLESS - PAN HEAD PHILLIPS
B142012-VS	1/4-20 X 1/2IN BOLT - STAINLESS - TRUSS HEAD PHILLIPS - VIBRASEAL
B142058-VS	1/4-20 X 5/8IN BOLT - STAINLESS - TRUSS HEAD PHILLIPS - VIBRASEAL
B5161834-HH	BOLT - 5/16-18 X 3/4IN - STAINLESS STEEL - HEX HEAD
BPB142038	1/4-20 X 3/8IN BINDING POST BARREL - STAINLESS - TRUSS HEAD PHILLIPS
BR10	BLOCK BRUSH FOR BOOT SCRUBBER SOLE - POLYPROPYLENE
BR10S	BLOCK BRUSH FOR BOOT SCRUBBER SIDE - POLYPROPYLENE
BRKT-FMPL-SS2	BRACKET FOR SS2 FLOOR MOUNT PLATE - STAINLESS STEEL
CHN-JC35	JC35 bead chain tether assembly
CLMPTB38-ADJ	CLAMP FOR 1/4 IN OD TUBE - PLASTIC - ADJUSTABLE
CV14HB14M	CHECK VALVE - PVC - 1/4 BARB X 1/4 MNPT - 302SS SPRING - VITON SEALS - AIR FLOW RIGHT
CV14M14HB	CHECK VALVE - PVC - 1/4 MNPT X 1/4 BARB - 302SS SPRING - VITON SEALS - AIR FLOW LEFT
CVSS18MF	CHECK VALVE - STAINLESS STEEL - 1/8 MPT X 1/8 FPT - 1LB STAINLESS STEEL SPRING - VITON SEALS
DBSH	DEBRIS SHIELD FOR MANUAL BOOT SCRUBBER - STAINLESS STEEL
DBTR	DEBRIS TRAY FOR MANUAL BOOT SCRUBBER - STAINLESS STEEL
EL14M14F	1/4 FPT X 1/4 MPT - POLYPRO ELBOW
FCN12016	FULL CONE NOZZLE - PVDF - 120DEG - 16GPH
FMHPL-SS2	FLOOR MOUNT PLATE FOR SS2 AND HANDLE - STAINLESS STEEL
FMPL-SS2	FLOOR MOUNT PLATE FOR SS2 - STAINLESS STEEL
FRM-SS2	FRAME - SS2 - STAINLESS STEEL
FW14NPT	FLAT WASHER FOR 1/4IN NPT - STAINLESS - 0.57IN ID X 1.28IN OD X 0.08IN THK
GR38	GROMMET - 3/8IN ID X 5/8IN OD X 3/32IN THK - FOR 7/16IN DIAMETER PANEL HOLE
GRT-SS2	GRATE - SS2 - STAINLESS STEEL
H14CL-PV	1/4IN ID 3/8IN OD CLEAR HOSE - PVC - AVAILABLE PER FT
H38CL-PV	3/8IN ID 3/8IN OD CLEAR HOSE - PVC - AVAILABLE PER FT
HBSSEL1814	STAINLESS HOSE BARB 1/8 MPT X 1/4 BARB ELBOW
HNDL-FS	HANDLE BAR - FOOTWEAR SANITIZER - STAINLESS STEEL
HNDL-FS-C	HANDLE BAR - FOOTWEAR SANITIZER AND MANUAL BOOT SCRUBBER COMBO - STAINLESS STEEL
HSGA-SS2	HOUSING ASSEMBLY - SS2 - MECHANISM MOUNTING PLATE - RUBBER FEET - INCLUDES MOUNTING HARDWARE
J2.5	2.5 GALLON NATURAL JUG

ITEM NUMBER	DESCRIPTION
J2.5-SR	2.5 GALLON SUCTION FITTINGS REPLACEMENT KIT (SUCTION TUBE, COUPLER, PLUG)
JC35B	BLACK 3.5 INCH ONE WAY VENTED CAP POLYPROPYLENE WITH GASKET AND CHECK VALVE
JC35B-P	BLACK 3.5 INCH CAP-POLYPROPYLENE
CV-JC35	EPDM CHECK VALVE FOR NON LOCKING JUG CAP
JC-G35	JUG CAP GASKET 3.5 INCH CAP EPDM
LN1032	LOCKNUT - 10-32 - STAINLESS - NYLON INSERT
LN1420	LOCKNUT - 1/4-20 - STAINLESS - NYLON INSERT
LN516	LOCKNUT - 5/16-18 - STAINLESS - NYLON INSERT
MBS100-C-BASE	MANUAL BOOT SCRUBBER FLOOR MOUNT BRACKET - FOOTWEAR SANITIZER BASE - STAINLESS STEEL - INCLUDES 2X B5161834-HH AND LN516
MN-SS2	MANIFOLD - SS2 - 1/8IN NPT - 6 PORTS - PVC
MPL-SS2	MOUNT PLATE FOR SS2 -STAINLESS STEEL
P18	PLUG 1/8 MPT HEX HEAD 304 SS
PMPA-FLD-SS2	PUMP ASSEMBLY - SS2 - FLUID - INCLUDES SPRING AND SEALS
QCPP14HB-HAST	1/4IN IN-LINE HOSE BARB - POLYPRO BODY - HASTELLOY SPRING
QCPP-M-HAST	3/8IN PANEL MOUNT SOCKET - SUCTION 3/8 ID X QUICK CONNECT - HASTELLOY SPRING - 11/16-24 THREAD
QF14P	QUICK FIT-1/4 MPT X 1/4 OD TUBE-POLYPROPYLENE
QF1814	QUICK FIT-1/8 MPT X 1/4 OD TUBE-POLYPRO
QFEL18	FIXED ELBOW 1/4in TUBE X 1/8in MPT - BRASS
QFEL1814	FIXED ELBOW 1/8in MPT X 1/4in TUBE - POLYPROPYLENE
R16	AIR REGULATOR - 1/4fpt TWO PORT 1/8fpt TWO PORT - NO AIR BOWL/FILTER
RFT12	RUBBER FOOT - 1/2IN TALL - INCLUDES INTERNAL WASHER
RSPG1	RADIAL SPRING - 1IN DIAMETER - RUBBER
SHR-SS2	SHROUD - SS2 - DRILLED OUT
SO142012	1/4-20 X 1/2 IN THREADED STANDOFF - STAINLESS
SPG-FLDPMP-SS2	SPRING - SS2 - FLUID PUMP
SPGRD-SS2	SPRAY GUARD FOR SS2 UNITS
SSA14	STAINLESS ADAPTOR 1/4 MPT X 1/4 FPT
SSJR2-P	SS RACK TO MOUNT CHEMICAL TRANSPORT JUG
TB14BL-PU	1/4IN OD BLUE TUBE - POLYURETHANE - AVAILABLE PER FT
TB14N-PE	1/4IN OD NATURAL TUBE - POLYETHYLENE - AVAILABLE PER FT
TRD5161114	5/16IN OD X 11 1/4IN LONG THREADED ROD - 5/16-18 END THREADS - STAINLESS
TW1532	15/32 TOOTH WASHER-STAINLESS
VLVA-3W2P-SS2	VALVE ASSEMBLY - 3 WAY 2 POSITION - SS2 - INCLUDES TOOTH WASHERS AND NUTS
WMS14	#14 X 1 1/4IN WALL MOUNT SCREW - STAINLESS - HEX HEAD SLOTTED
WMS14A	#14 X 1 1/4IN WALL MOUNT SCREW ANCHOR - PLASTIC - 5/16IN DRILL SIZE